



C.U.I. RO15564229, Nr. Inreg. R.C. J10/558/2003
 Sediul social: BERCA, str. Plesești, jud. BUZAU
 Capital social subscris și varsat: 400 LEI
 Cont IBAN: RO09 BRDE 100S V041 6457 1000
 Deschis la BRD sucursala Berca

Telefon: +4 0238 510 851
 Fax: +4 0338 819 339
 Mobil: +4 0746 043 026
 E-mail: contact@bibiscom.ro
 Web site: www.bibiscom.ro

ROATA LANT PAS 1"1/4 x 3/4 "

S P R O C K E T S

ASA 100

| Z | d _e | d _p | SINGLE | | | DOUBLE | | |
|----|----------------|----------------|----------------|----------------|----|----------------|----------------|----|
| | | | d _m | D ₁ | A | d _m | D ₁ | A |
| 8 | 98.1 | 82.96 | 53 | 20 | 40 | | | |
| 9 | 108.0 | 92.84 | 63 | 20 | 40 | | | |
| 10 | 117.9 | 102.74 | 70 | 20 | 40 | | | |
| 11 | 127.8 | 112.68 | 77 | 20 | 45 | | | |
| 12 | 137.8 | 122.68 | 88 | 20 | 45 | 90 | 20 | 80 |
| 13 | 147.8 | 132.65 | 98 | 20 | 45 | 100 | 20 | 80 |
| 14 | 157.8 | 142.68 | 108 | 20 | 45 | 110 | 20 | 80 |
| 15 | 167.9 | 152.72 | 118 | 20 | 45 | 120 | 20 | 80 |
| 16 | 177.9 | 162.75 | 120 | 25 | 50 | 120 | 25 | 80 |
| 17 | 187.9 | 172.78 | 120 | 25 | 50 | 120 | 25 | 80 |
| 18 | 198.0 | 182.85 | 120 | 25 | 50 | | | |
| 19 | 208.1 | 192.91 | 120 | 25 | 50 | | | |
| 20 | 218.1 | 202.98 | 120 | 25 | 50 | | | |
| 21 | 228.2 | 213.04 | 140 | 25 | 55 | | | |
| 22 | 238.3 | 223.11 | 140 | 25 | 55 | | | |
| 23 | 248.3 | 233.17 | 140 | 25 | 55 | | | |
| 24 | 258.4 | 243.23 | 140 | 25 | 55 | | | |
| 25 | 268.5 | 253.33 | 140 | 25 | 55 | | | |

Pitch 1" 1/4 x 3/4 "

for roller chains in compliance with
 DIN 8188-ISO/R 606 - ANSI B 29.1

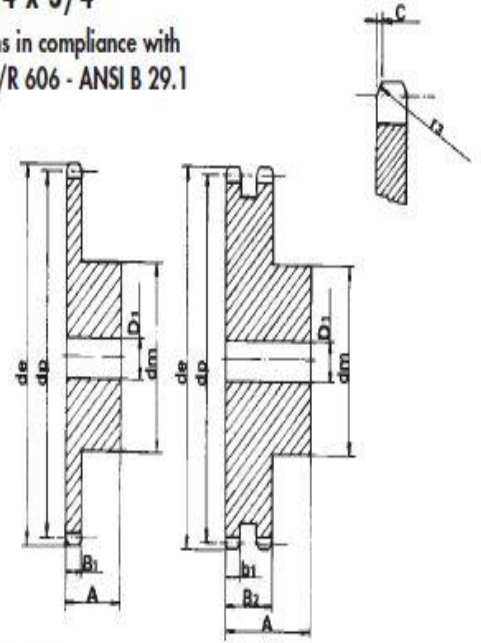

SPROCKET

mm

| | |
|-------------------------------------|------|
| TOOTH RADIUS r ₃ | 33.5 |
| RADIUS WIDTH C | 4 |
| SPROCKET TOOTH WIDTH B ₁ | 18.0 |
| SPROCKET TOOTH WIDTH b ₁ | 17.7 |
| SPROCKET TOOTH WIDTH B ₂ | 53.5 |
| SPROCKET TOOTH WIDTH B ₃ | 89.2 |

CHAIN

mm

| | |
|-------------|-------|
| PITCH | 31.75 |
| INNER WIDTH | 19.05 |
| ROLLER - Ø | 19.05 |

MATERIAL: C 45 UNI 7845

