



C.U.I. RO15564229, Nr. Inreg. R.C. J10/558/2003
 Sediul social: BERCA, str. Plesesti, jud. BUZAU
 Capital social subscris si varsat: 400 LEI
 Cont IBAN: RO09 BRDE 100S V041 6457 1000
 Deschis la BRD sucursala Berca

Telefon: +4 0238 510 851
 Fax: +4 0338 819 339
 Mobil: +4 0746 043 026
 E-mail: contact@bibiscom.ro
 Web site: www.bibiscom.ro

ROATA LANT PAS 8x3MM

Z	d_e	d_p	SINGLE			DOUBLE		
			d_m	D_1	A	d_m	D_1	A
8	24.0	20.90	13	6	12	12	8	18
9	26.6	23.39	15	6	12	15	8	18
10	29.2	25.89	17	8	12	17	8	18
11	31.7	28.39	18	8	13	19	10	18
12	34.2	30.91	20	8	13	21	10	18
13	36.7	33.42	23	8	13	24	10	18
14	39.2	35.95	25	8	13	26	10	18
15	41.7	38.48	28	8	13	29	10	18
16	44.3	41.01	30	8	14	32	10	20
17	46.8	43.53	30	8	14	34	10	20
18	49.3	46.07	30	8	14	37	10	20
19	51.9	48.61	30	8	14	39	10	20
20	54.4	51.14	30	8	14	40	10	20
21	57.0	53.68	35	8	14	40	10	20
22	59.5	56.21	35	8	14	40	10	20
23	62.0	58.75	35	8	14	40	10	20
24	64.6	61.29	35	8	14	40	10	20
25	67.5	63.83	35	8	14	40	10	20
28	69.5	66.37	40	10	16	50	12	22
27	72.2	68.91	40	10	16	50	12	22
28	74.8	71.45	40	10	16	50	12	22
29	77.3	73.99	40	10	16	50	12	22
30	79.8	76.53	40	10	16	50	12	22
31	82.4	79.08	40	10	16	60	12	22
32	84.9	81.61	40	10	16	60	12	22
33	87.5	84.16	40	10	16	60	12	22
34	90.0	86.70	40	10	16	60	12	22
35	92.5	89.25	40	10	16	60	12	22
36	95.0	91.79	40	10	16	60	12	22
37	97.6	94.33	40	10	16	60	12	22
38	100.2	96.88	40	10	16	60	12	22
39	102.7	99.42	40	10	16	60	12	22
40	105.3	101.97	40	10	16	60	12	22
45	118.0	114.69	60	12	20			
50	130.7	127.41	60	12	20			
57	148.6	145.22	80	14	20			
76	197.7	193.59	80	20	25			

8 x 3 mm

for roller chains in compliance with DIN 8187 ISO/R 606

The plate size is increased by $h = 4\text{mm}$ for Z.57 and Z.76

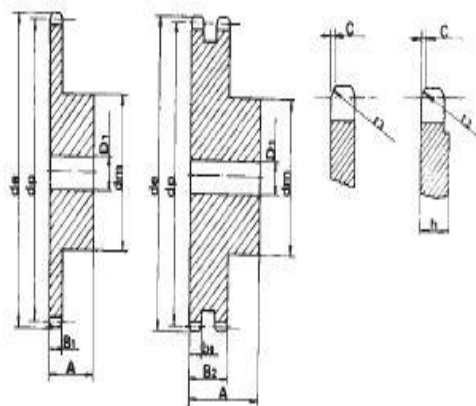

SPROCKET mm

TOOTH RADIUS r_3	8
RADIUS WIDTH C	1.0
SPROCKET TOOTH WIDTH B_1	2.8
SPROCKET TOOTH WIDTH b_1	2.7
SPROCKET TOOTH WIDTH B_2	8.3

CHAIN mm

PITCH	8
INNER WIDTH	3
ROLLER - \emptyset	5

MATERIAL: C 45 UNI 7845

