

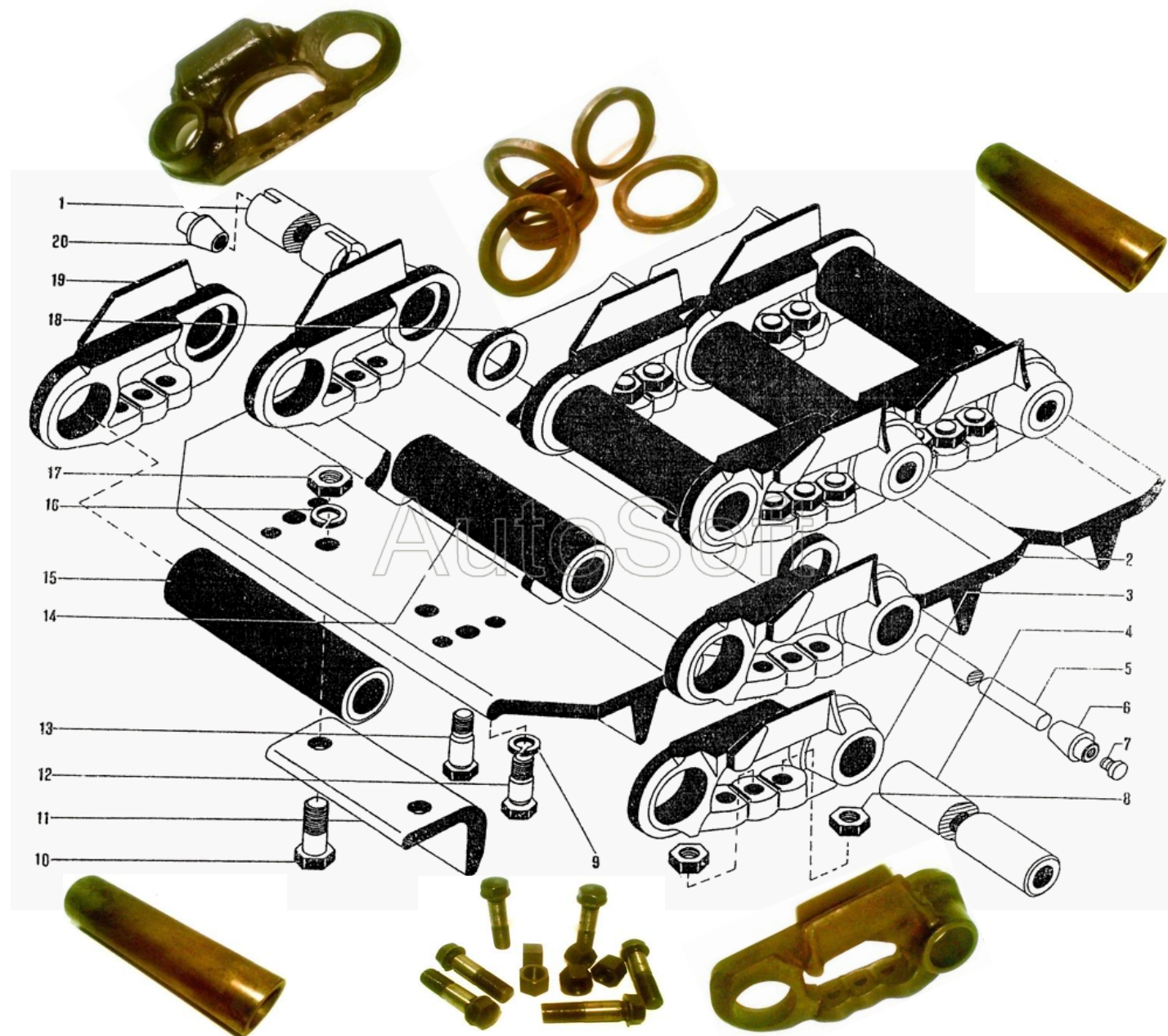

WE SELL TRACKER &amp; TRUCK SPARE PARTS

Senila Buldozer DET-250M2



Nr. Desen	Cod reper	Denumire reper	
-	748-22-158-01СП	Segment senila (11 zale)	5
-	748-22-158-03СП	Segment senila (27 zale)	1
-	748-22-158-04СП	Segment senila (18 zale)	1
-	748-22-158СП	Segment senila (1 za)	1
1	748-22-74	Bolt inchidere lant	1
2	748-22-81	Talpa senila	1
3	748-22-76	Za (legatura)	1
4	748-22-79	Bolt lant	10
5	748-22-19	Tija	3
6	748-22-8	Dop conic blocare	3
7	700-40-5128	Surub	3
8	30326-1	Piulita M20x1,5mm	6
9	Шайба 20 ОТ 65Г 09 [ГОСТ 6402-70]	Saiba D20	6

10	Болт М24-8gx70.109.40X [ГОСТ 7796-70]	Surub M24-8gx70.109.40X	224
11	748-22-45	Pinten	112
12	700-28-232	Surub M20x1,5x78mm	2
13	700-28-233	Surub M20x1,5x78mm	4
14	748-22-78	Bucsa bolt de inchidere	1
15	748-22-77	Bucsa bolt lant	10
16	24 T 65Г 09 [ГОСТ 6402-70]	Saiba grover 24 T 65G 09	224
17	Гайка М24-7Н.6.019 [ГОСТ 5915-70]	Piuli ă M24-7N.6.019	224
18	748-22-9	Saiba distantier	6
19	748-22-75	Za (legatura)	1
20	748-22-7	Dop conic blocare	3

748-22-76 ZA LANT

748-22-75 ZA LANT

