

TECHNICAL SPECIFICATION

Bases for high power safety devices

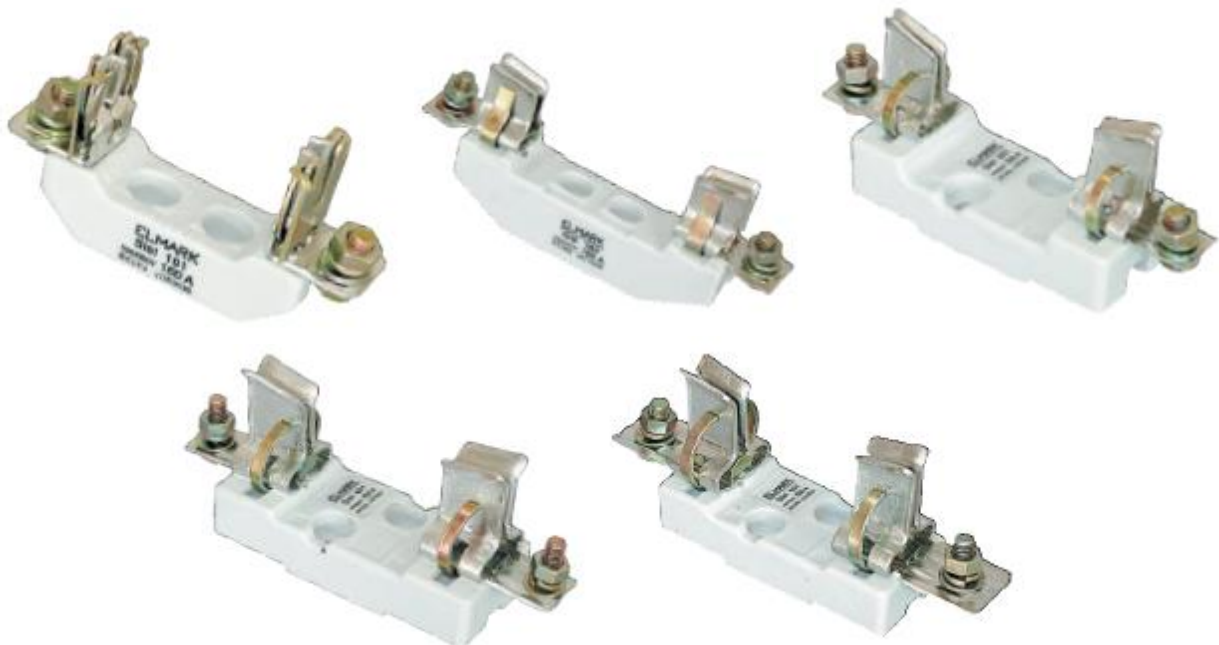

Description:

The series bases for high power safety device is manufactured of permittivity alloy with mounted contact jaws of electrolytic copper supplied with special springs for contact compression and easy fuse links taking out. All current leading parts are connected to inlet outlet terminals with bolts; the terminals also end with bolts, to which the power supply conductors are connected. The bases are offered in five type sizes corresponding to the five types of fuse links.

Overall dimensions:

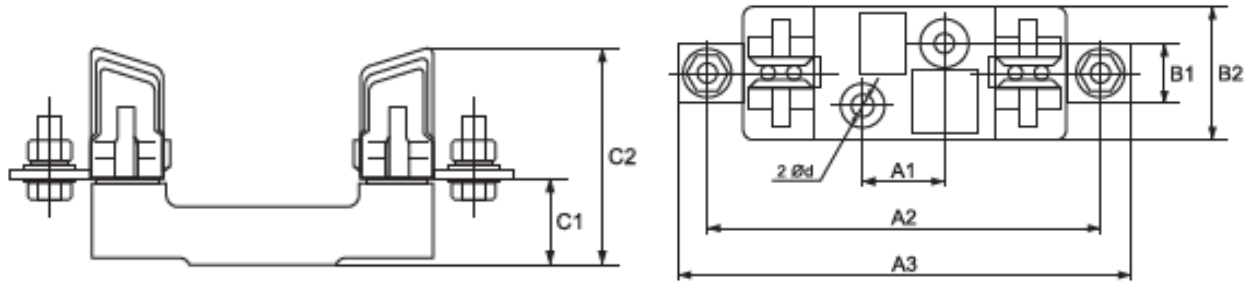

Base type	A1	A2	A3	B1	B2	C1	C2	d
SIST00	25	100	120	-	30	25	60	7.5
SIST 0	25	150	170	-	30	37	72	7.5
SIST1	25	175	200	30	58	38	84	10.5
SIST2	25	200	225	30	60	38	100	10.5
SIST3	25	210	250	30	60	40	105	10.5

Variants:

Base type	Fuse link type	Rated current (A)	Rated voltage Un (V)	Weight (gr)	Packing / box (pcs)	Catalogue number
SIST00	NT 00	Up to 160	600	193	5 / 120	12001
SISP00	NT 00	Up to 160	600	215	5 / 120	12001P

Remark: Fuse bases SISP are made of porcelain

Base type	Fuse link type	Rated current (A)	Rated voltage Un (V)	Weight (gr)	Packing / box (pcs)	Catalogue number
SIST0	NT 0	Up to 160	600	295	3 / 54	12010
SISP0	NT 0	Up to 160	600	319	3 / 54	12010P

Remark: Fuse bases SISP are made of porcelain

Base type	Fuse link type	Rated current (A)	Rated voltage Un (V)	Weight (gr)	Packing / box (pcs)	Catalogue number
SIST1	NT 1	Up to 250	600	550	3 / 36	12100
SISP1	NT 1	Up to 250	600	550	3 / 36	12010P

Remark: Fuse bases SISP are made of porcelain

Base type	Fuse link type	Rated current (A)	Rated voltage Un (V)	Weight (gr)	Packing / box (pcs)	Catalogue number
SIST2	NT 2	Up to 400	600	770	1 / 20	12200
SISP2	NT 2	Up to 400	600	810	1 / 20	12200P

Remark: Fuse bases SISP are made of porcelain

Base type	Fuse link type	Rated current (A)	Rated voltage Un (V)	Weight (gr)	Packing / box (pcs)	Catalogue number
SIST3	NT 3	Up to 630	600	965	1 / 15	12300
SISP3	NT 3	Up to 630	600	987	1 / 20	12300P

Remark: Fuse bases SISP are made of porcelain

Standards:

EN60269-1

