

C6xDC

— number of poles (1,2)
 — breaking capacity in (kA)
 — tripping curve C

C x — rated current in (A)
 — tripping curve C

Documents corresponding to the product:

Standard EN60898-1
 EN60898-2

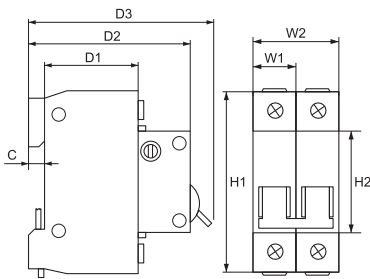
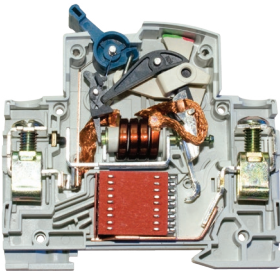

Miniature circuit breakers (MCB) C60DC series

7 YEAR WARRANTY *for industrial usage, 3 years warranty

Functions:

- for lowering constant current voltaic arc and use of the breaker at constant current consumer protection
- protection of the electrical circuits from overload or short circuit of the outer circuit at alternating current and constant current power supply circuits
- for commutation and control of electrical circuits
- in combination with auxiliary alternating current devices for remote control, commutation or indication of the protected circuit
- for mounting in industrial buildings
- for protection of consumers generating short circuit currents to 6000 A at alternating current power supply

Technical data:

- Rated voltage: 240V; AC/DC
- Breaking capacity (cycle O -CO) in accordance with standard EN 60 898- 1: 6000A
- Rated breaking capacity $I_{cs}=75\% I_{cu}$
- Insulating voltage: $\geq 2000V$
- Electrical wear resistance (number of cycles): ≥ 4000
- Mechanical wear resistance (number of cycles): ≥ 20000
- Class of current limiting: 3
- IP code: IP>20
- Tripping curve: C – the maximum current release breaks between 5 and 10 In; used to protect power supply cables and conventional consumers
- Joining terminal: flat (tunnel) screw terminal with composition 1.5 coldly draw-plated plane Q235– A
- Plastic box – not keeping the burning material nylon PA66, UV rays wear resistance
- Box permittivity strength: >18MV/m
- Abnormal heating wear resistance and fire of the outer parts: 960°C / 3s
- Maximum current release containing:
 - copper coil - composition: pure copper T2 type
 - resistance: from 0.6 to 180m

- welding effort: <150 000 N/mm
- bimetal plate – composition: 5J158 to TB180 according to the current
- thickness: 0.6mm (up to 40A) and 0.8mm (up to 63A)
- magnetic core – composition: coldly draw-plated metal wire (1Gr18Ni9)
- thickness: 1.15 to 2.24µm
- drawing effort: from 200 to 400N/mm
- contact head of the movable contact – composition: silver graphite CAg(5)
- dimension 3x3x0.8 (up to 40A) and 4x4x0.8 (up to 63A)
- static contact – composition: pure copper T2Y2
- composition of the contact head: silver graphite CAg(5)
- metal magnetic plate for lowering the constant current arc
- Conducting:
 - power supply busbar 1P63, 2P63
 - rigid conductors up to 25 mm
 - flexible conductors up to 16 mm
- Tightening moment: 1.33Nm

Mounting

- vertical
- DIN-rail
- for mounting in housing or industrial environment without serious current interference
- Ambient temperature: -5°C to +65°C±2° C

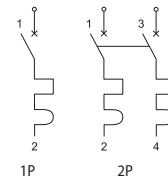

Dimensions (mm)

	C	D1	D2	D3
	5	49	65	72
	H1	H2	W1	W2
	78	45	18	36

(D curve)

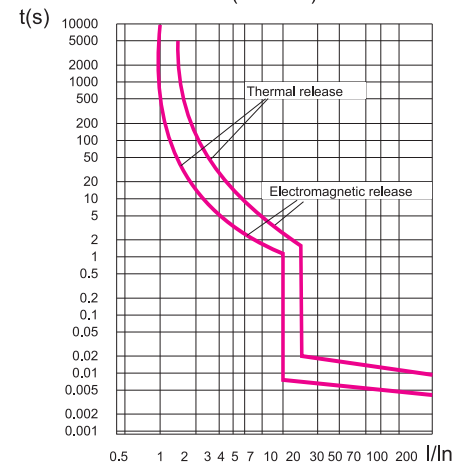

Miniature circuit breakers (MCB)



Type	Number of poles	Rated current I _n (A)	Breaking capacity (kA)	Recommended sections of the conductor (g/mm ²)	Packing/Box (pcs)	Catalogue number Curve C
61DC / 1A	1P	1	6	1.0	12 / 240	41164
61DC / 2A	1P	2	6	1.0	12 / 240	41165
61DC / 4A	1P	4	6	1.0	12 / 240	41166
61DC / 6A	1P	6	6	1.0	12 / 240	41167
61DC / 10A	1P	10	6	1.5	12 / 240	41168
61DC / 16A	1P	16	6	2.5	12 / 240	41169
61DC / 20A	1P	20	6	2.5	12 / 240	41170
61DC / 25A	1P	25	6	4.0	12 / 240	41171
61DC / 32A	1P	32	6	6.0	12 / 240	41172
61DC / 40A	1P	40	6	10.0	12 / 240	41173
61DC / 50A	1P	50	6	10.0	12 / 240	41174
61DC / 63A	1P	63	6	16.0	12 / 240	41175



Type	Number of poles	Rated current I _n (A)	Breaking capacity (kA)	Recommended sections of the conductor (g/mm ²)	Packing/Box (pcs)	Catalogue number Curve C
62DC / 2A	2P	2	6	1.0	6 / 120	41176
62DC / 4A	2P	4	6	1.0	6 / 120	41177
62DC / 6A	2P	6	6	1.0	6 / 120	41178
62DC / 10A	2P	10	6	1.5	6 / 120	41179
62DC / 16A	2P	16	6	2.5	6 / 120	41181
62DC / 20A	2P	20	6	2.5	6 / 120	41182
62DC / 25A	2P	25	6	4.0	6 / 120	41183