



**MACCHINA SMUSSATRICE AV1 - AV2**  
**SKIVING MACHINE AV1 - AV2**  
**MACHINE A PARER AV1 - AV2**

**AV1**

**AV2**

**CON ASPIRATORE**  
**WITH EXHAUSTER**  
**AVEC ASPIRATEUR**



Le smussatrici mod. **AV1** e **AV2** sono caratterizzate da semplicità e precisione. Sono largamente impiegate nel campo calzaturiero e nella pelletteria in genere.

Vengono fornite nelle varie versioni:

- a) solo testa
- b) con tavolo e motore
- c) con tavolo e motore aspiratore (solo per la AV2)
- d) con tavolo, motore trasporto e motore super-aspirazione

Il mod. **AV2** nelle versioni **b) c) d)** può avere inoltre la velocità di trasporto variabile con regolazione elettronica.

Skiving machines **AV1** and **AV2** are known for their simplicity and precision. They are largely used in shoes and leathergoods industries.

They are supplied in the following versions:

- a) head only
- b) complete with table and motor
- c) complete with table and motor exhauster (only for AV2)
- d) complete with table, transport motor and motor super-exhauster.

The **AV2** mod. in the types **b) c) d)** can be equipped with the optional variable speed of transport with electronic adjustment.

Les machines à parer peaux Mod. **AV1** et **AV2** sont caractérisées par leur simplicité et leur précision; elle sont largement utilisées dans l'industrie des chaussures et de la maroquinerie.

Elles sont fournies dans les versions suivantes:

- a) seulement tête
- b) avec table et moteur
- c) avec table et moteur aspirateur (Mod. AV2 seulement)
- d) avec table, moteur pour le transport et moteur super aspirateur.

Le mod. **AV2** dans les types **b) c) d)** peut être équipé avec une optionale vitesse variable d'entraînement avec réglage électronique.

		Mod. AV1			Mod. AV2			
		a	b	d	a	b	c	d
Altezza / Height / Hauteur	cm	38	115	115	38	115	115	115
Larghezza / Width / Largeur	cm	54	105	105	54	105	105	105
Profondità / Depth / Profondeur	cm	40	55	55	40	55	55	55
Peso netto / N.W. / P.N.	Kg	37	73	92	38	78	80	87
Peso netto / N.W. / P.N. con velocità variabile / with variable speed / avec vitesse variable					Kg	93	95	102

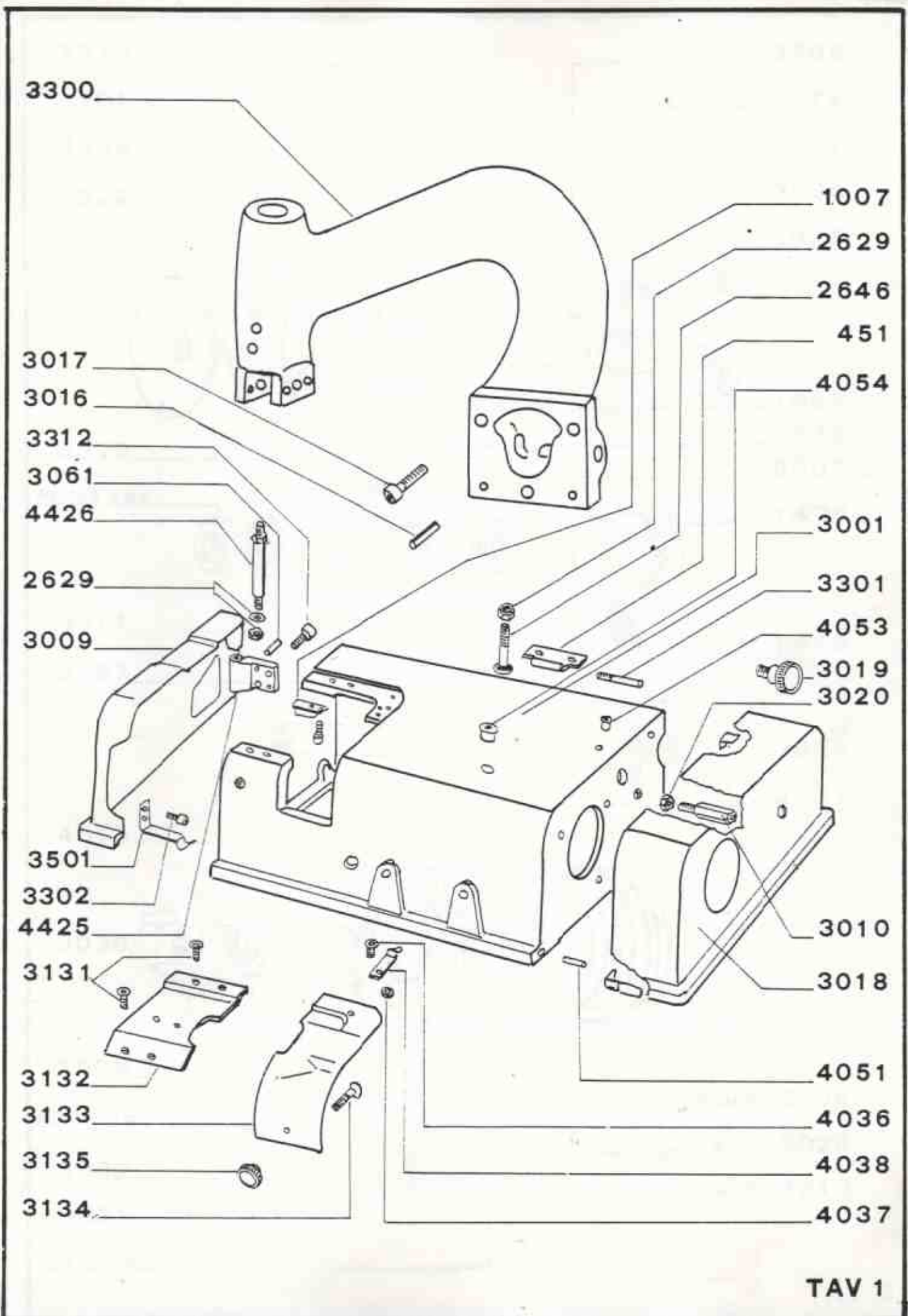



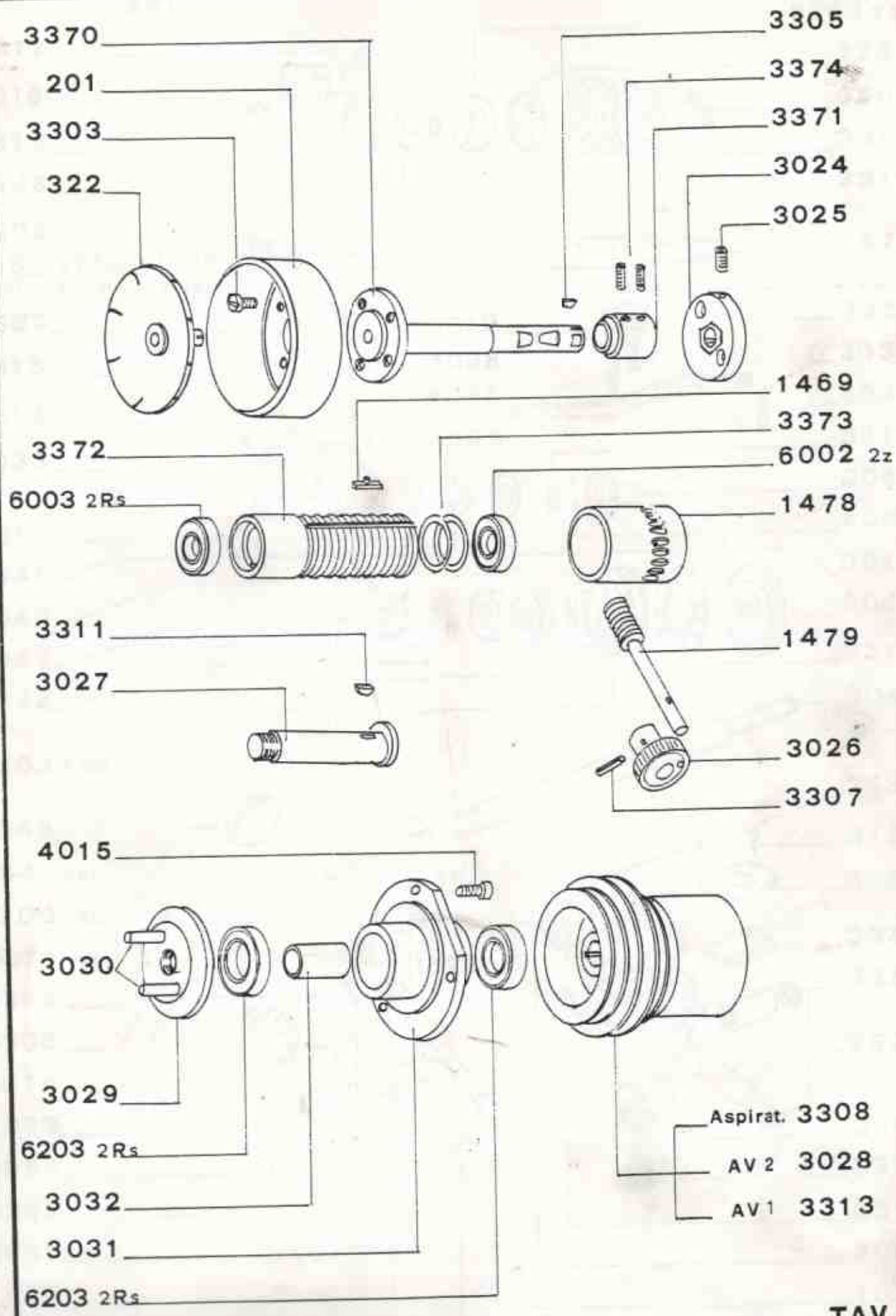

AV1

6203 2 RS

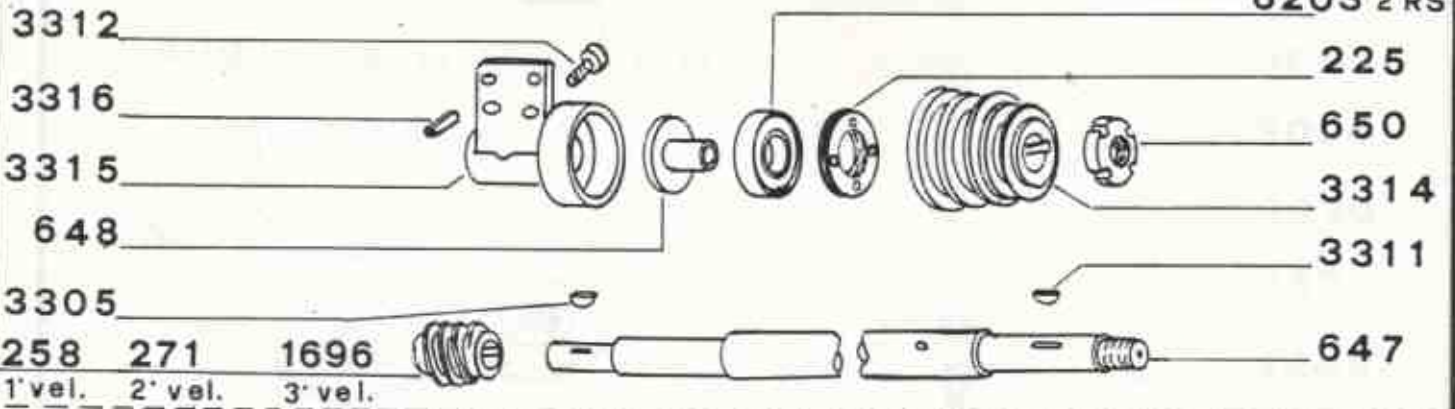

AV 2

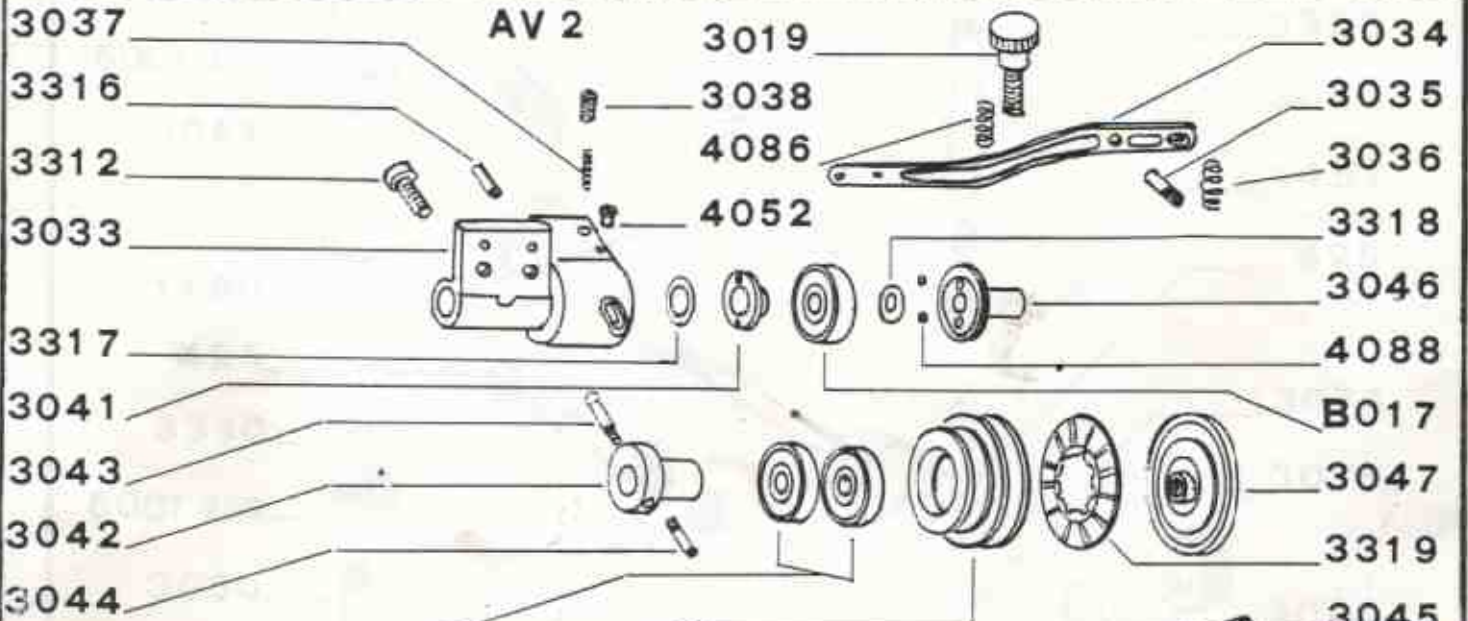

6203 2 RS

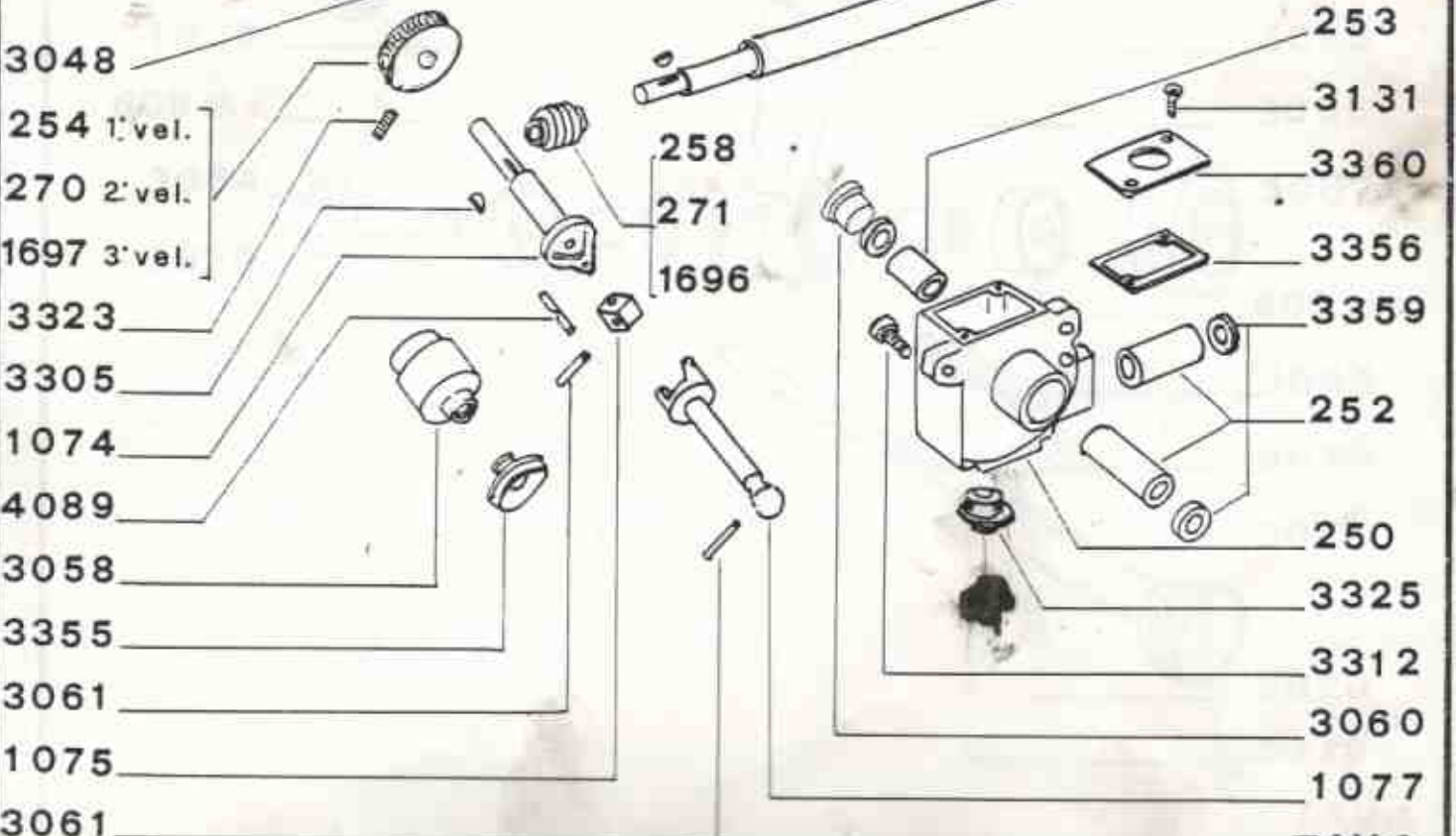

TAV 3



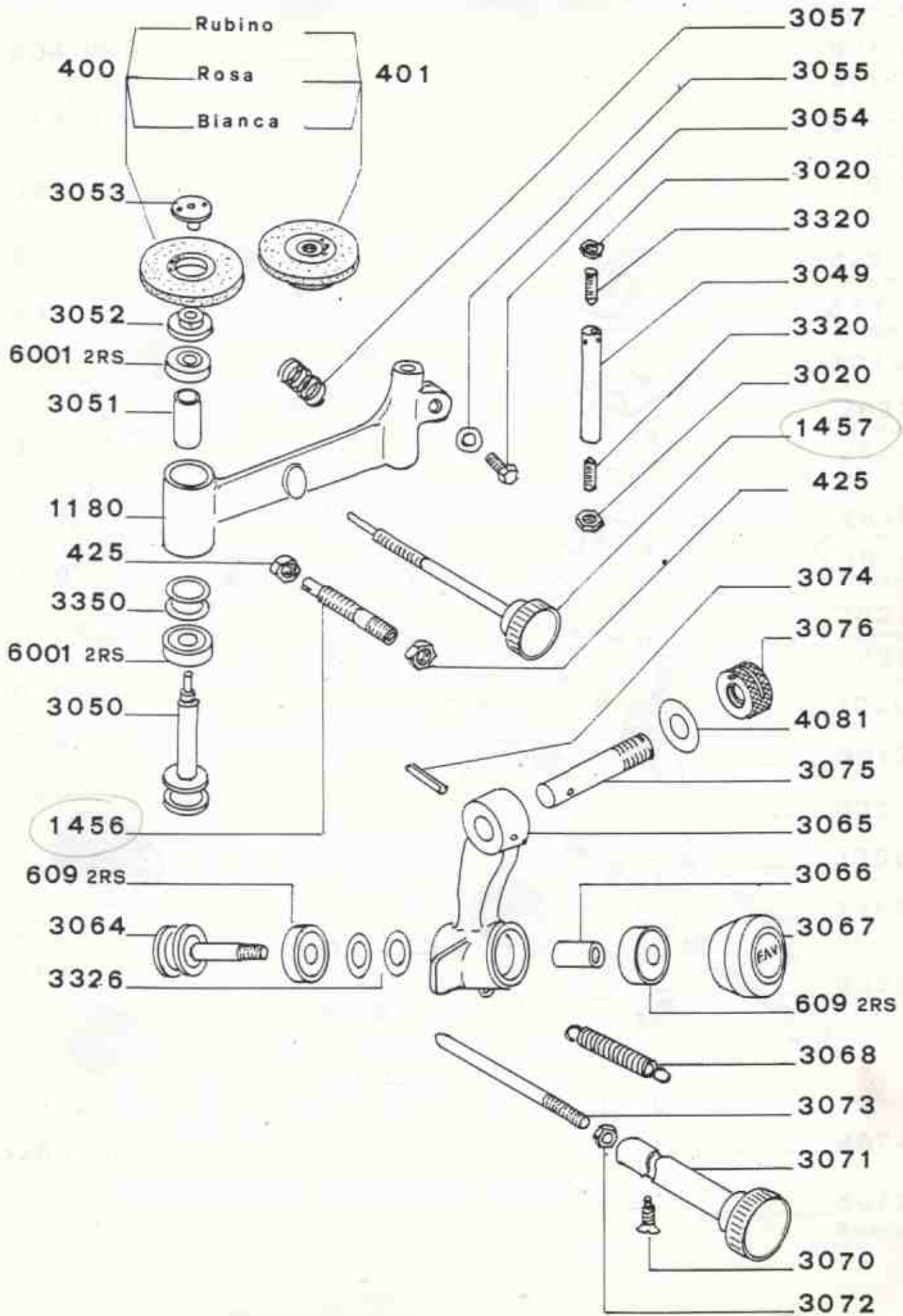

TAV 4

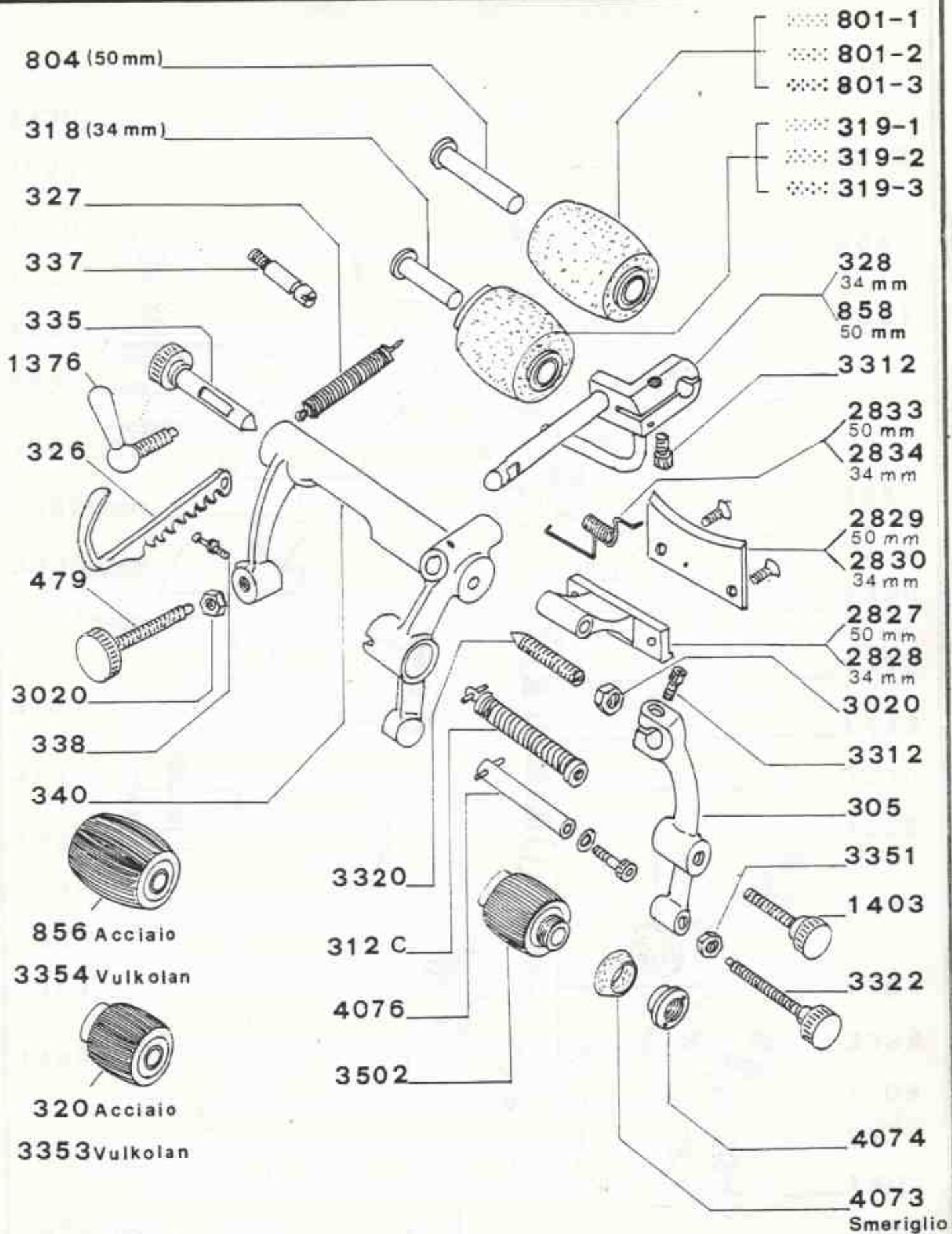

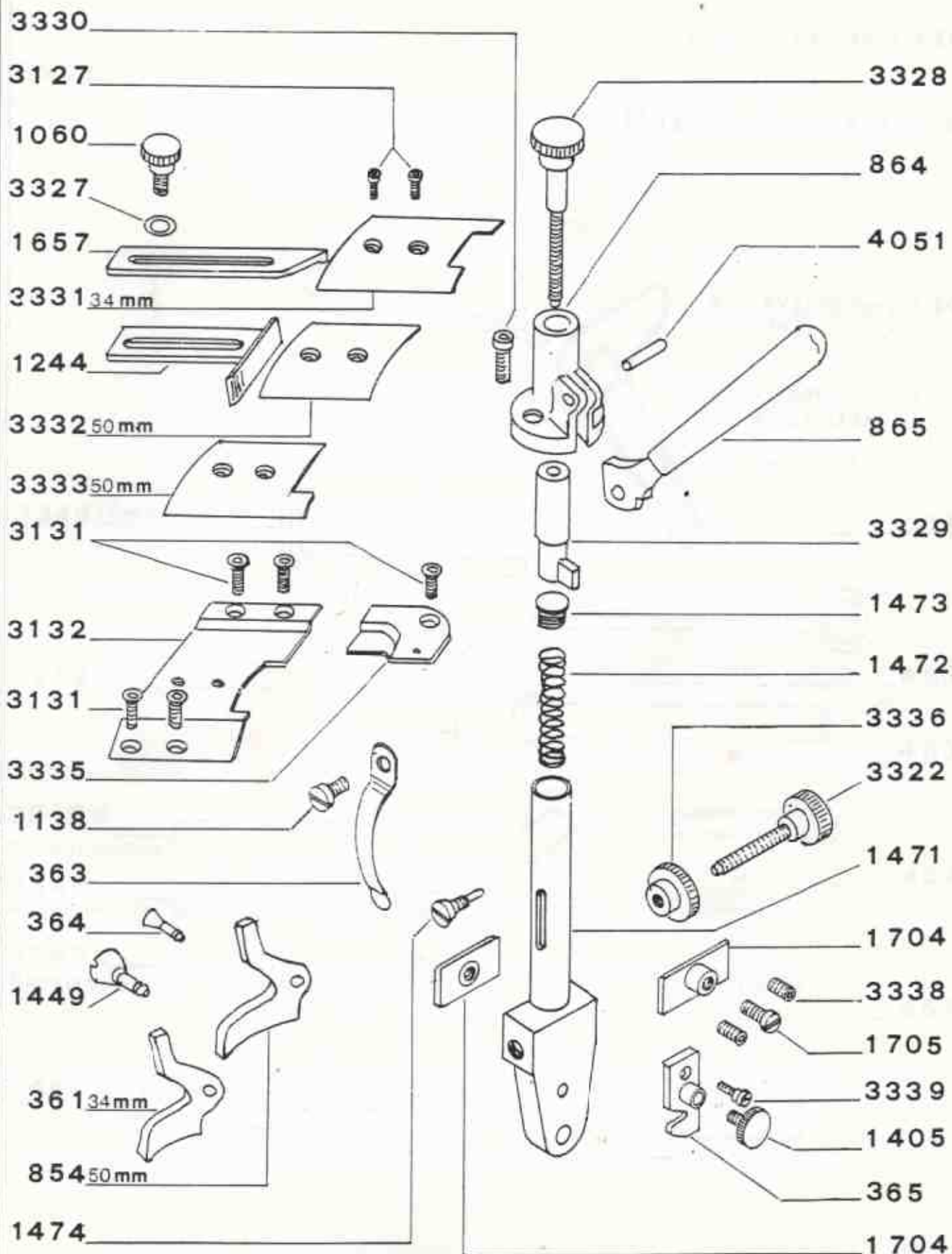



3343

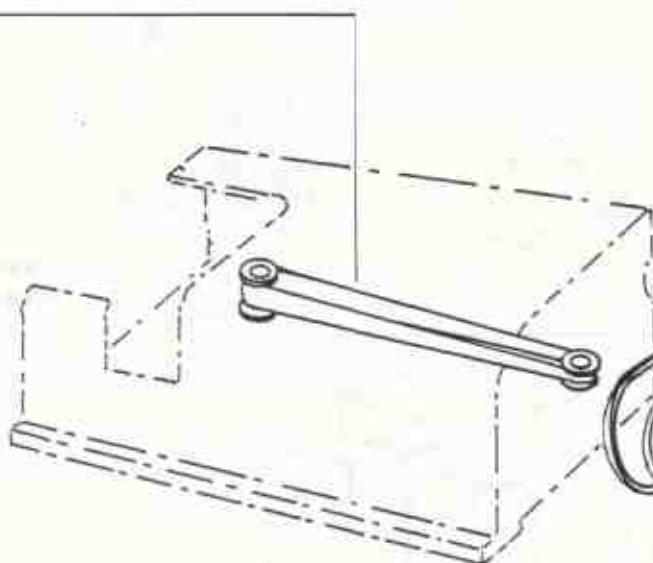

(498x8x5 per AV1) 3344

(z 20 1/2 540 per AV2) 3345

AV1-AV2 Standard 3346

z 28 1/2

z 38 1/4 969 per AV2 3347

Aspiratore

3348 (5mm)



325



212

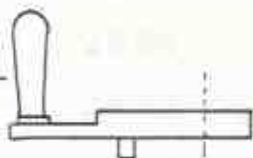

453 a

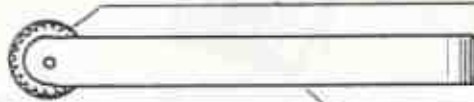

453

3349 B

Carborondum



3349

Levafilo



3349 C

Ravvivamola



454

461

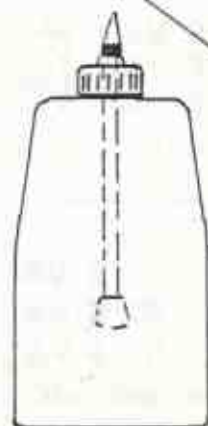
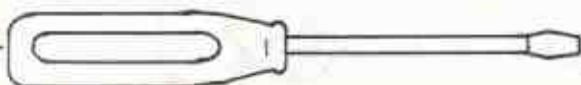

458



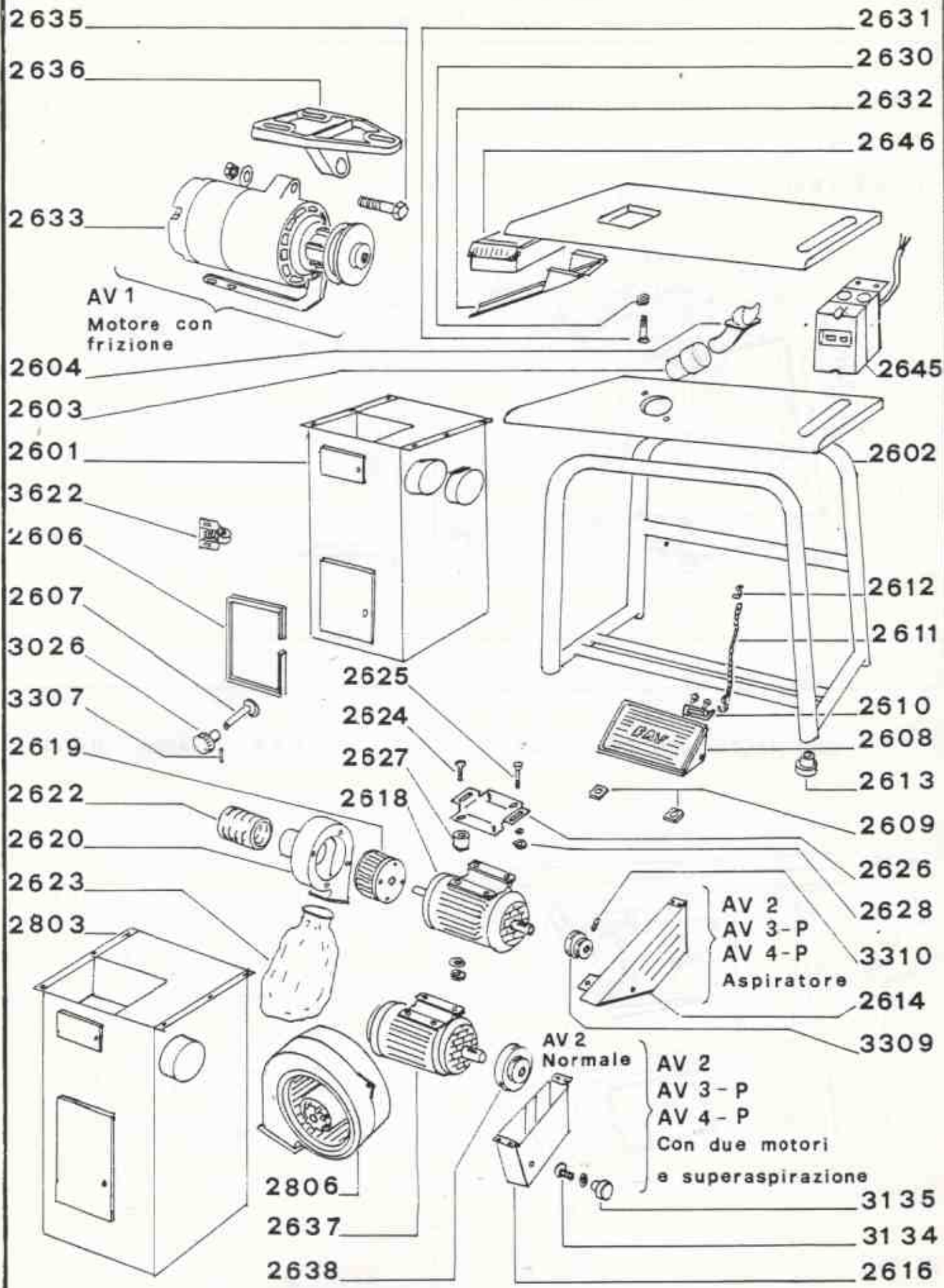

TAVOLO NORMALE 2802

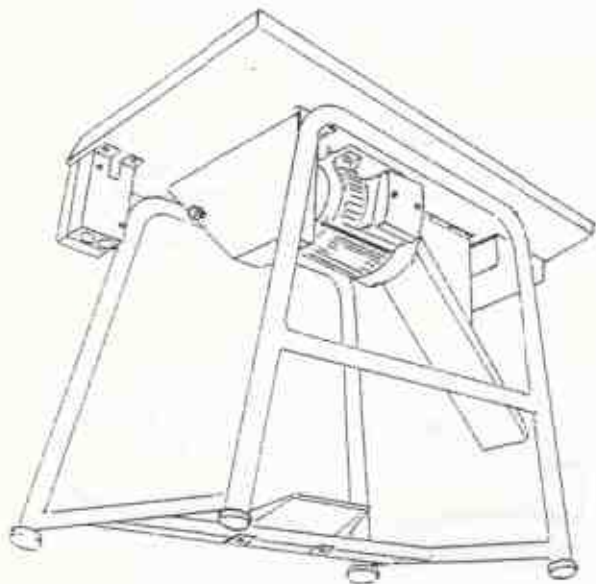

TAVOLO CON SUPERASPIRATORE 2600

AV 3 P 2700

AV 4 P 2800

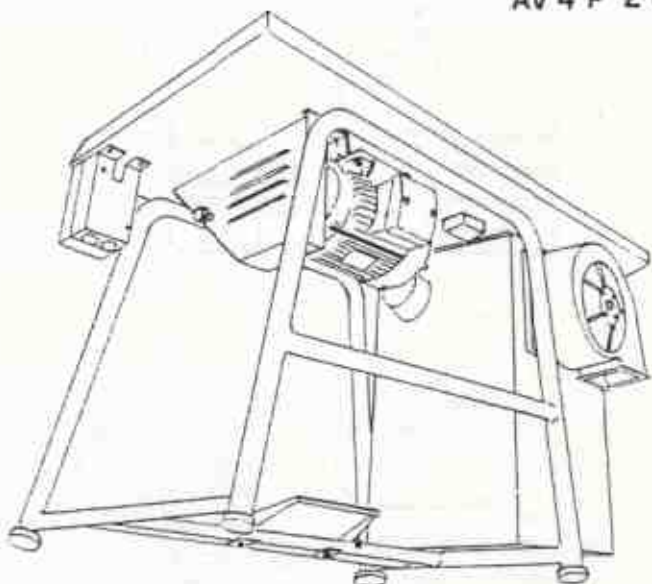

AV 1

TAVOLO NORMALE 2801

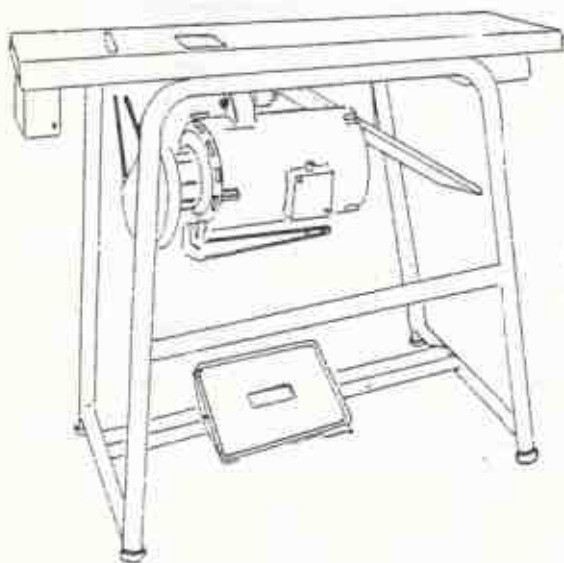

TAVOLO CON SUPERASPIRATORE

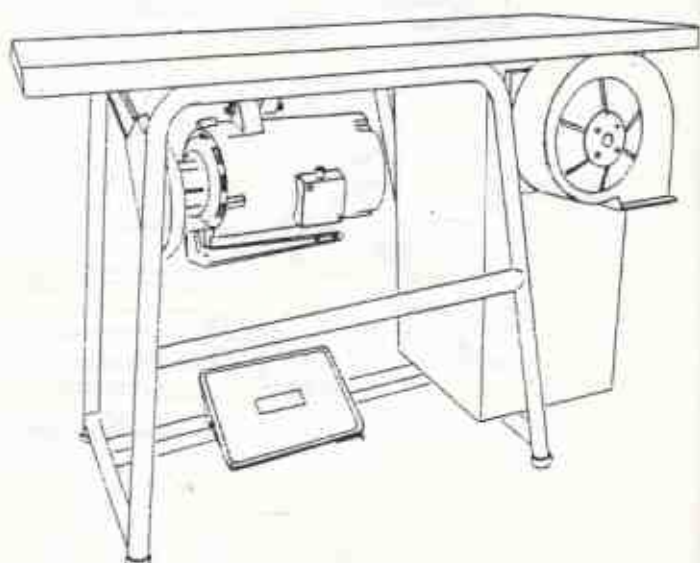



# ACCESSORI PER LA SMUSSATURA - PIEDINI -

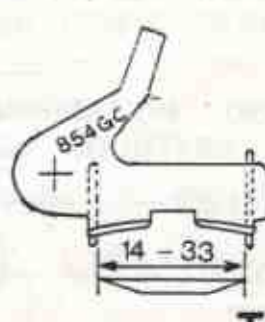
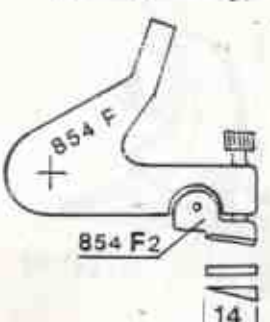
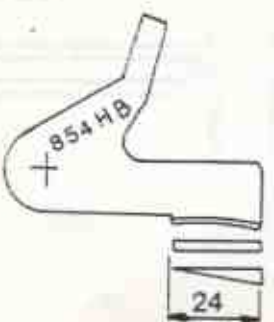
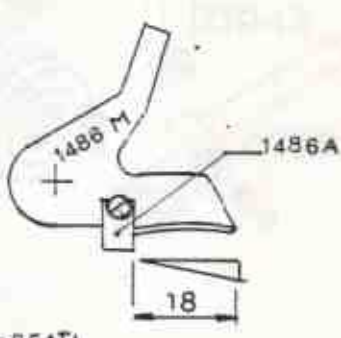
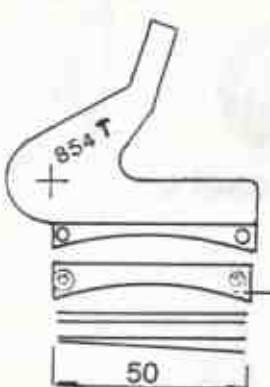
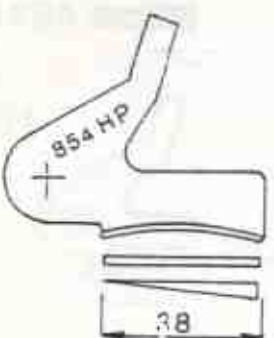
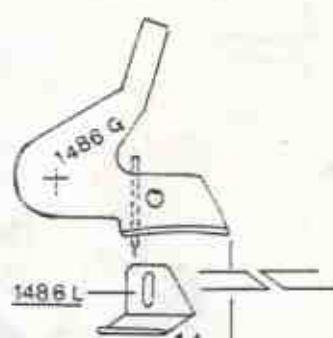
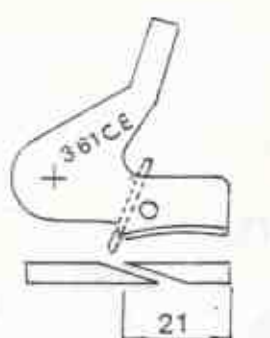
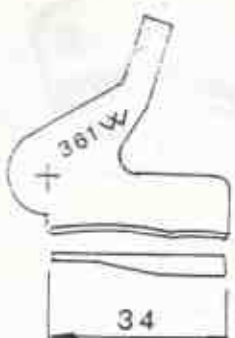
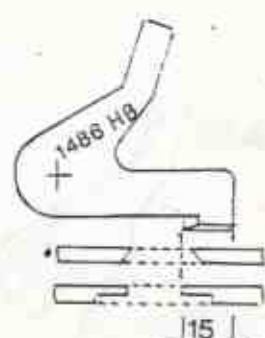
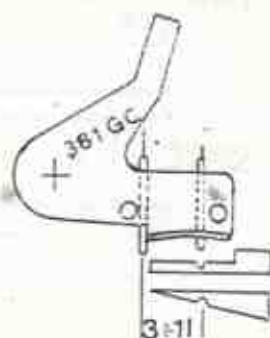
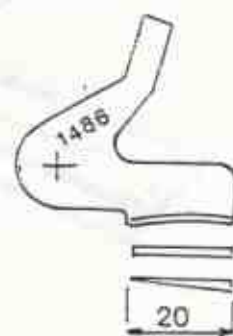

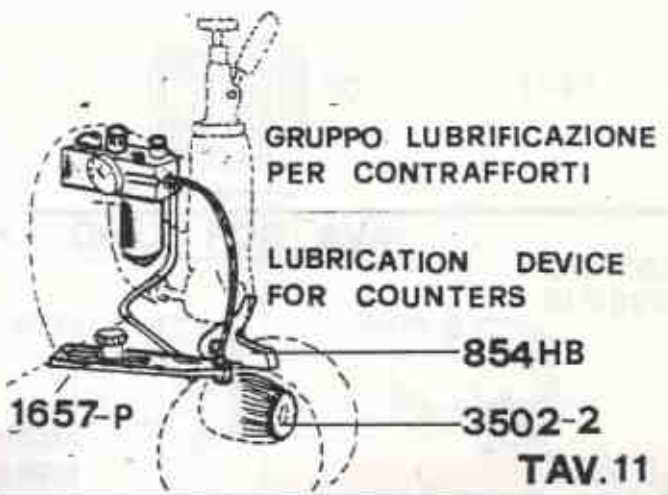
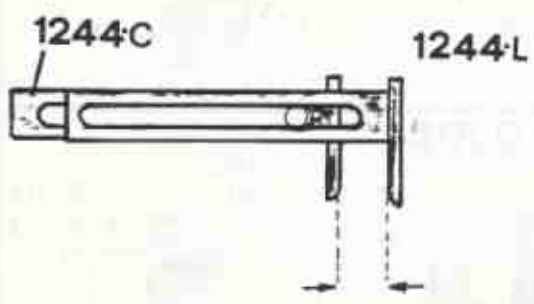
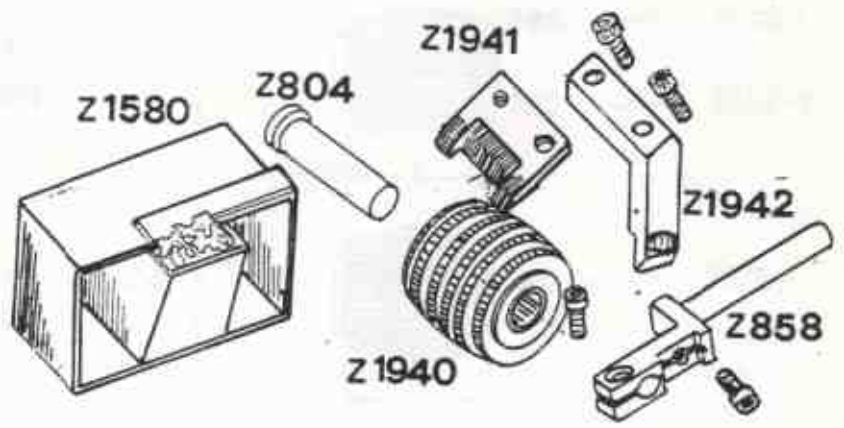
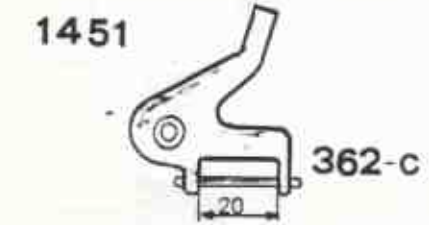
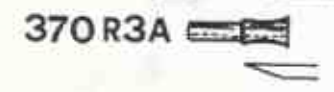
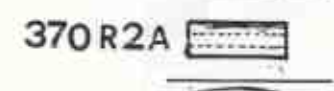
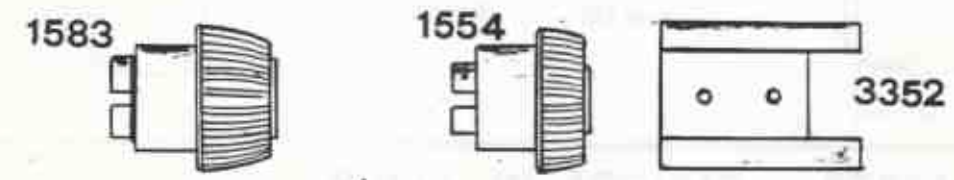
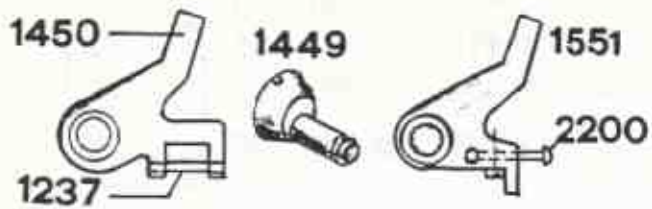

GRUPPO LUBRIFICAZIONE  
PER CONTRAFFORTI

LUBRICATION DEVICE  
FOR COUNTERS

854HB

3502-2

TAV.11



### RULLI IN SMERIGLIO - EMERY ROLLS

GRANA GRAIN	PART.N°	L
280 fine	319-1	34mm
60 media	319-2	
36 grossa	319-3	



GRANA GRAIN	PART.N°	L
280 fine	801-1	50mm
60 media	801-2	
36 grossa	801-3	

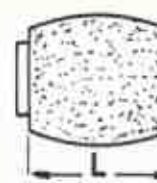

### RULLI IN GOMMA - RUBBER ROLLS

SHORE	PART.N°	L
90	3353	34 mm
90	3353-S	40 mm

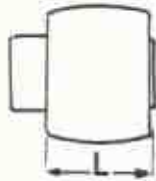
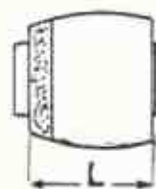

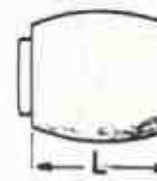
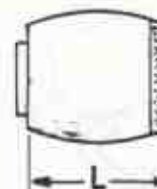

SHORE	PART.N°	L
90	3354	50 mm
90	3509	50 mm





### RULLI IN ACCIAIO - STEEL ROLLS

DENTI TEETH	PART.N°	L mm
180	320-1	34
120	320-2	
80	320-3	
120	320-SE-2	



DENTI TEETH	PART.N°	L mm
180	856-1	50
120	856-2	
80	856-3	
120	856-SE-2	



DENTI TEETH	PART.N°	L
120	1554 (45°)	15



DENTI TEETH	PART.N°	L
180	3502-1	50
120	3502-2	

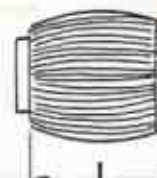

DENTI TEETH	PART.N°	L
120	1583 (45°)	24

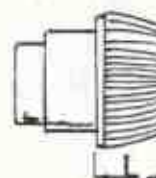

DENTI TEETH	PART.N°	L
120	10750	50



DENTI TEETH	PART.N°	L
180	3548-1	22
120	3548-2	

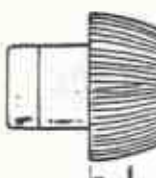

DENTI TEETH	PART.N°	L
80	1940	50



### SOLO PER AV4 - ONLY FOR AV4

DENTI TEETH	PART.N°
180	4070-1
120	4070-2

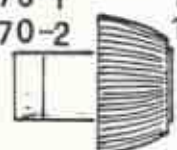

DENTI TEETH	PART.N°
180	4072-1
120	4072-2



PART.N°	GOMMA RUBBER
4075	



PART.N°	GOMMA RUBBER
4075-S	



TAV 12

PARTICOLARE PER AV2 E

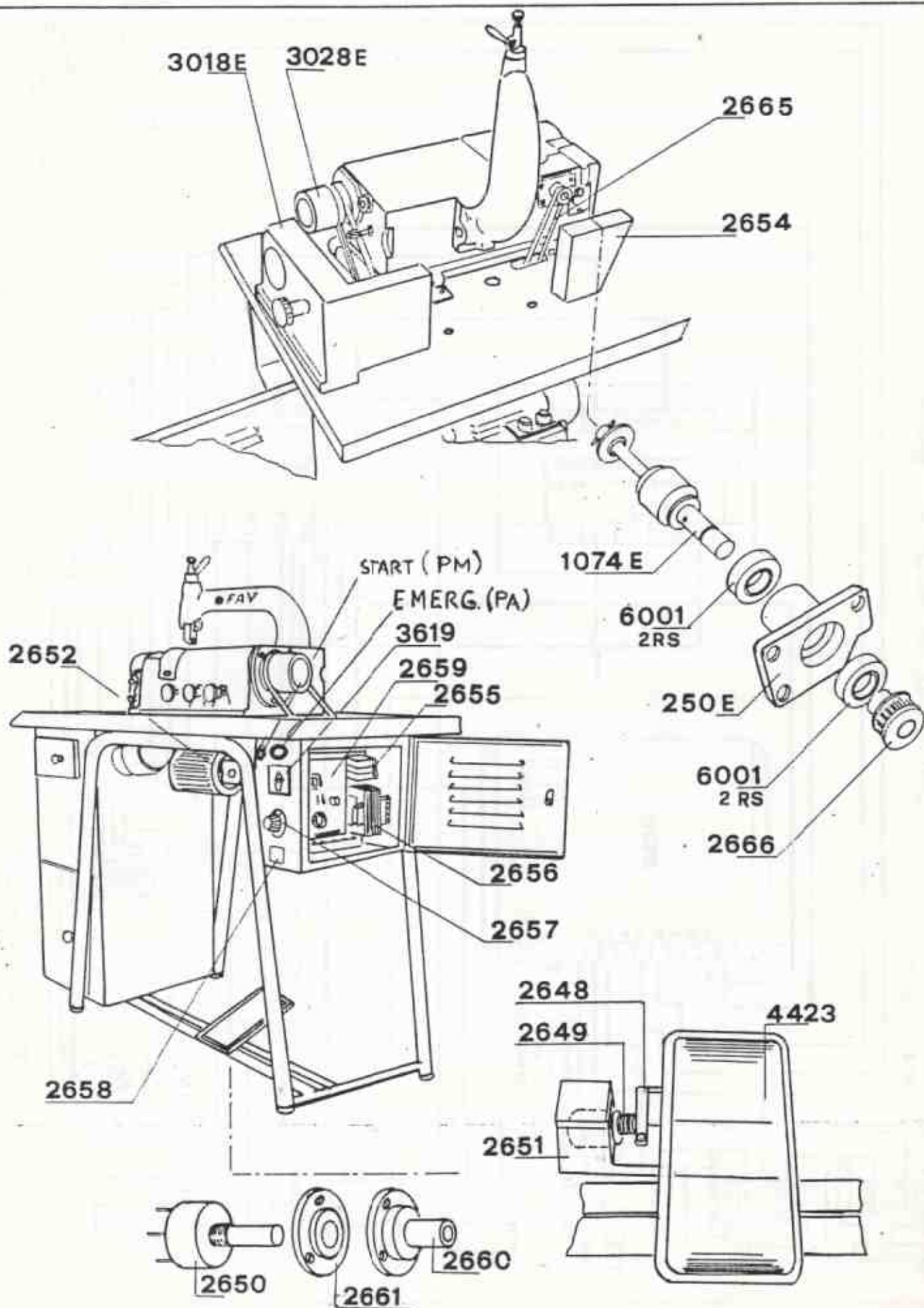



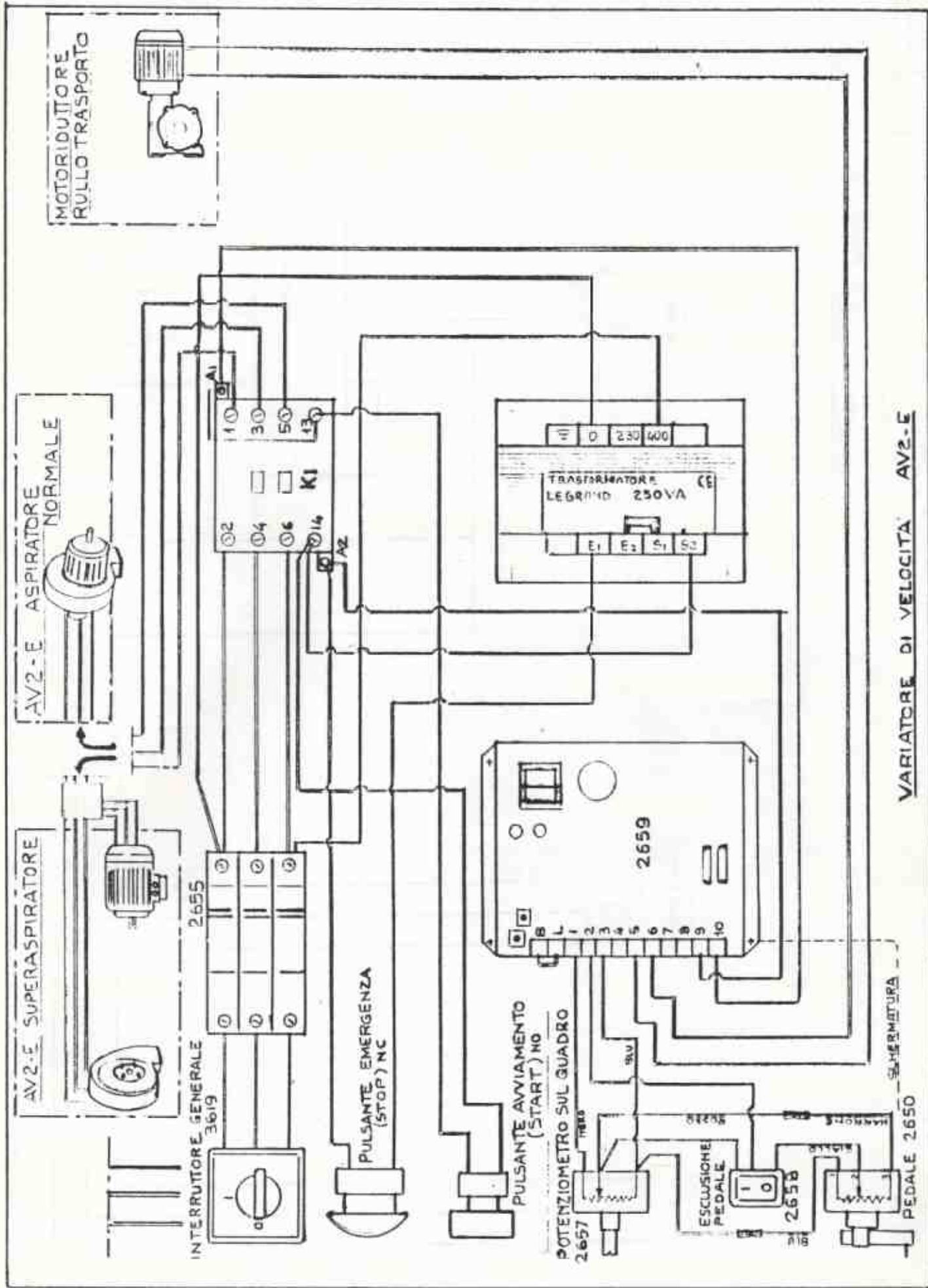

VARIATORE DI VELOCITÀ AV2-E

