

Rubber Suspension Units

Type DR-A

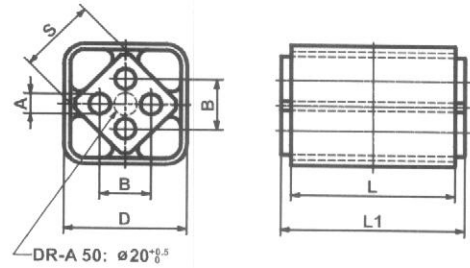

Type DR-C

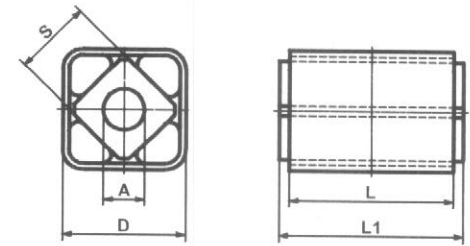

DR-A				DR-C							
Art. No.	Type	$\varnothing A \begin{smallmatrix} +0.5 \\ 0 \end{smallmatrix}$	B	Art. No.	Type	$\varnothing A$	$\square D$	$\square S$	L	L1 ± 0.2	Weight [kg]
01 011 001	DR-A 15x 25	5	10 ± 0.2	01 031 010	DR-C 15x 25	10 $\begin{smallmatrix} +0.4 \\ +0.2 \end{smallmatrix}$	27 $\begin{smallmatrix} +0.4 \\ 0 \end{smallmatrix}$	15	25	30	0.06
01 011 002	DR-A 15x 40			01 031 011	DR-C 15x 40				40	45	0.10
01 011 003	DR-A 15x 60			01 031 012	DR-C 15x 60				60	65	0.15
01 011 004	DR-A 18x 30	6	12 ± 0.3	01 031 001	DR-C 18x 30	13 $\begin{smallmatrix} 0 \\ -0.2 \end{smallmatrix}$	32 $\begin{smallmatrix} +0.3 \\ -0.1 \end{smallmatrix}$	18	30	35	0.10
01 011 005	DR-A 18x 50			01 031 002	DR-C 18x 50				50	55	0.16
01 011 006	DR-A 18x 80			01 031 003	DR-C 18x 80				80	85	0.25
01 011 007	DR-A 27x 40	8	20 ± 0.4	01 031 004	DR-C 27x 40	16 $\begin{smallmatrix} +0.5 \\ +0.3 \end{smallmatrix}$	45 $\begin{smallmatrix} +0.4 \\ 0 \end{smallmatrix}$	27	40	45	0.25
01 011 008	DR-A 27x 60			01 031 005	DR-C 27x 60				60	65	0.36
01 011 009	DR-A 27x100			01 031 006	DR-C 27x100				100	105	0.60
01 011 010	DR-A 38x 60	10	25 ± 0.4	01 031 007	DR-C 38x 60	20 $\begin{smallmatrix} +0.5 \\ +0.2 \end{smallmatrix}$	60 $\begin{smallmatrix} +0.3 \\ -0.2 \end{smallmatrix}$	38	60	70	0.60
01 011 011	DR-A 38x 80			01 031 008	DR-C 38x 80				80	90	0.79
01 011 012	DR-A 38x120			01 031 009	DR-C 38x120				120	130	1.16
01 011 023	DR-A 45x 80	12	35 ± 0.5	01 031 023	DR-C 45x 80	24 $\begin{smallmatrix} +0.5 \\ +0.2 \end{smallmatrix}$	75 $\begin{smallmatrix} +0.3 \\ -0.2 \end{smallmatrix}$	45	80	90	1.25
01 011 024	DR-A 45x100			01 031 024	DR-C 45x100				100	110	1.53
01 011 025	DR-A 45x150								150	160	2.30
01 011 026	DR-A 50x120	M12x40	40 ± 0.5	01 031 025	DR-C 50x120	30 $\begin{smallmatrix} +0.5 \\ +0.2 \end{smallmatrix}$	80 $\begin{smallmatrix} +0.3 \\ -0.2 \end{smallmatrix}$	50	120	130	2.07
01 011 027	DR-A 50x200			01 031 026	DR-C 50x200				200	210	3.45
01 011 028	DR-A 50x300								300	310	5.15

List of torque and loads on page 1.5.

Further information to customized elements and installation examples as from page 1.14.

