

O.L.F. master 12/05



constant adjustment
of the crushing gap

4 or 6 impact bars

hybrid setting

tertiary impact crusher



it crushes

any kind of alluvial inert, limestone, gravel, pebbles and natural or pre-crushed stone with feed size between 4 and 120 mm, whatever their hardness and abrasivity are.

it produces

- thin sand with optimum granulometric curves and low presence of filler, so that it can be used dry or washed;
- polyhedral shapes with pre-determinable size, thanks to the special adjustment system of the machine.

it optimizes

the consumption of the wearable steel parts and impact bars, in order to minimize the weight waste of the castings.

It keeps a high efficiency and constancy upon time with respect to the thinness of the crushed product, regardless of the gradual wear of the steel parts.

CRUSHER WEIGHT
8.000 kg
POWER
55÷160 kW
ROTOR
4 or 6 impact bars
ROTOR ROTATIONS
450÷800 n/1'
CAPACITY RANGE
30÷105 t/h
FEED GRANULOMETRY
5÷120 mm
YIELD WITH HOLE Ø 6 mm
60÷80%
ROTATION SENSE
double
ADJUSTMENT RANGE OF THE CRUSHING GAP
150+150 mm

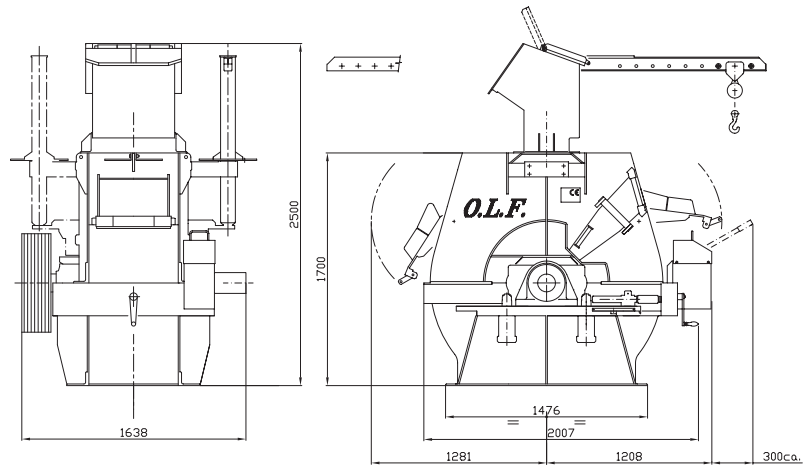

standard

- arm with block and tackle and hand truck
- support for the change of the impact bars
- rotor with radial double seat to house the impact bars, allowing a better exploitation of the consumption materials
- modular side shell, 50 mm thick
- downtime pulley bracket

master

OLF's MASTER impact crusher has been designed and built taking these basic parameters into consideration:

- efficiency
- versatility
- economical operation
- safety.

The rational and careful design has allowed lto build a very simple, solid and reliable machine, whose maintenance is limited, easy and intuitive.

The construction is precise and careful, made with suitable materials, selected according to high quality standards.

use

This new machine finds its ideal location in all those quarries and mining industries where it is needed to crush to produce sand and quality thin materials in large amounts.

OLF directly installs its impact crushers, by its own specialized personnel. OLF ensures the correct testing, the operators training, the spare parts supply and the maintainance of the machines.

The off the shelf machine is equipped with special chrome alloy steel castings or, according to specific customer's needs, with manganese steel, or other.

adjustments

The MASTER impact crusher is equipped with a 4 or 6 impact bars rotor, spinning alternatively in both senses. The adjustment acts on the rotor, whose rotation axis can be moved horizontally, adjusting the distance between the impact bars and the shell (crushing gap).

The adjustment, di tipo mechanical, is quick and easy and is executed by a crank handle device, checking on a proper millimetrata bar the rotor displacement. The rotor also allows a further radial displacement of the impact bars after the first working period, in order to optimize their wear.

A passive safety device allows to limit the damages, when metallic bodies accidentally came in the impact crusher.



hydraulic lock of the plates



impact bars' change support



mechanical adjustment of the crushing gap

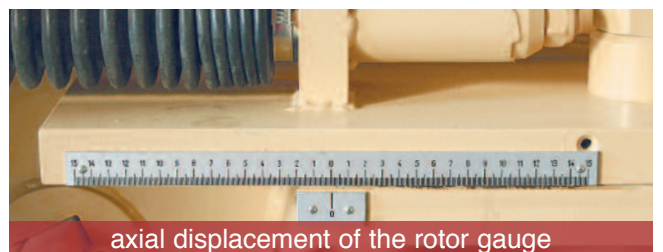

axial displacement of the rotor gauge

OLF

- secondary and tertiary impact crushers
- mechanical design and constructions



OLF

24040 CALVENZANO BG • via Milano, 19
tel. 0363 335 459 • fax 0363 335 608
olf@olf.it • www.olf.it