

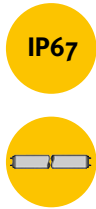

18W

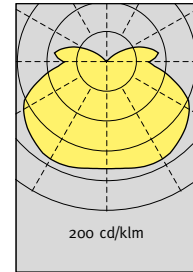

36W



Type 230V/ 50/60Hz	Part-no.	Code	Weight kg
2x18W	5108 0010 ...-xxx	183-218 Ex	4.6
2x36W	5108 0012 ...-xxx	183-236 Ex	6.3

Applications

hazardous areas
zone 1 and 2

Approvals

according to the rules
of relevant classification
societies, additional VDE
and IEC,
examination certificate
KDB 04 ATEX 339x

Protection type

EEx emd IIC T5

Protection class

IP 67

Insulation class

1

Ambient temp.

-20°C to +40°C

Housing

zinc coated steel, seam-
less deep drawn,
powder coated white

Diffuser

polycarbonate, clear

Lamp base

G 13

Lamps (not included)

fluorescent lamp
18W / 36W

Electric

electronic ballast
230V, 50/60Hz

Cable entry

2 EEx- e cable glands
for cables Ø 10-12.5 mm

Mounting

2 welded brackets,
4 mounting holes, Ø 8 mm

Options

- stainless steel housing

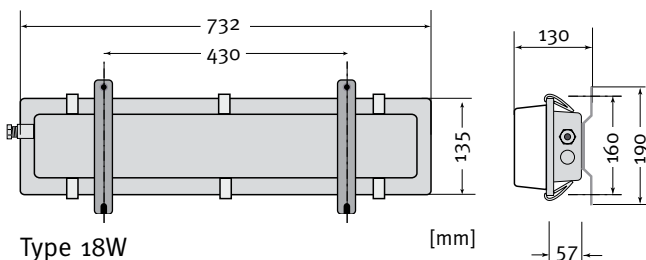

Type 18W

[mm]

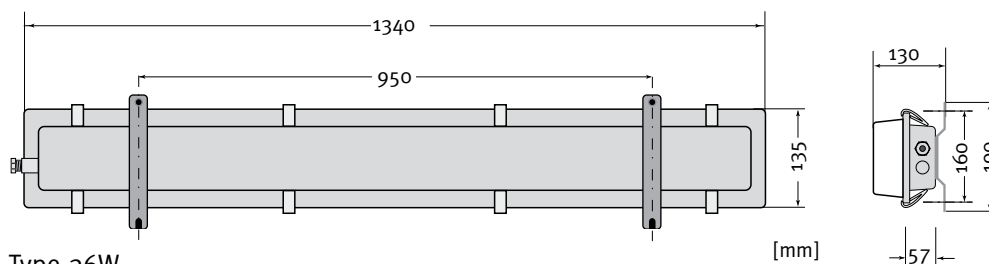

Type 36W

[mm]

