

**Equal Tee union (pipe-pipe-pipe)**

Mild Steel

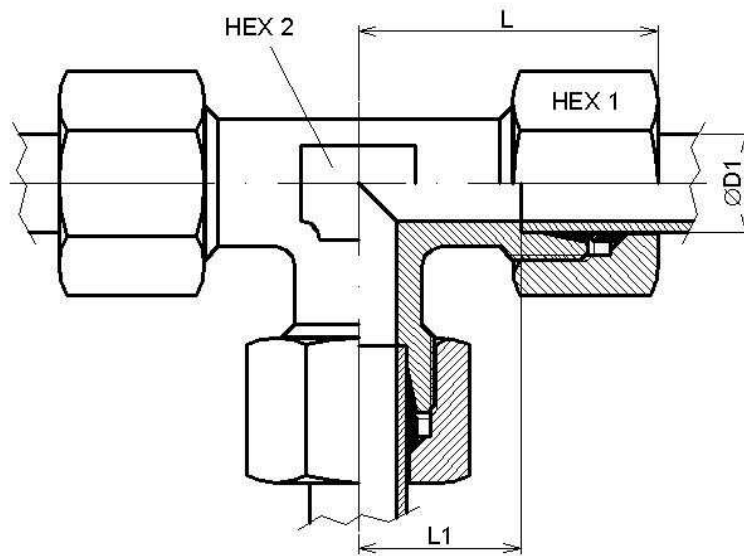

Part n°	ØD1	Serie	Working Pressure (bar)	L	L1	HEX 1	HEX 2
<b>TLL 4</b>	4	LL	100	21,0	11	10	9
<b>TLL 6</b>	6	LL	100	21,0	9,5	12	9
<b>TLL 8</b>	8	LL	100	23,0	11,5	14	12
<b>TL 6</b>	6	L	500	27,0	12	14	12
<b>TL 8</b>	8	L	500	29,0	14	17	12
<b>TL 10</b>	10	L	315	30,0	15	19	14
<b>TL 12</b>	12	L	315	32,0	17	22	17
<b>TL 15</b>	15	L	315	36,0	21	27	19
<b>TL 18</b>	18	L	315	40,0	23,5	32	24
<b>TL 22</b>	22	L	250	44,0	27,5	36	27
<b>TL 28</b>	28	L	250	47,0	30,5	41	36
<b>TL 35</b>	35	L	160	56,0	34,5	50	41
<b>TL 42</b>	42	L	160	63,0	40	60	50
<b>TS 6</b>	6	S	630	31,0	16	17	12
<b>TS 8</b>	8	S	630	32,0	17	19	14
<b>TS 10</b>	10	S	630	34,0	17,5	22	17
<b>TS 12</b>	12	S	630	38,0	21,5	24	17
<b>TS 14</b>	14	S	630	40,0	22	27	19
<b>TS 16</b>	16	S	420	43,0	24,5	30	24
<b>TS 20</b>	20	S	420	48,0	26,5	36	27
<b>TS 25</b>	25	S	420	54,0	30	46	36
<b>TS 30</b>	30	S	400	62,0	35,5	50	41
<b>TS 38</b>	38	S	315	72,0	41	60	50