



TIMER

# VORTICE LINEO V0

Ventilatoare axiale cu flux mixt, in-line

Proiectat pentru aplicatii rezidentiale, comerciale si industriale: bucatarii, bai, birouri, laboratoare, magazine, spalatorii, baruri, restaurante, teatre etc



- Modele cu diametre cuprinse intre 100 la 250.
- Carcasa motorului si elicea sunt realizate din polipropilena V0 ignifuga.
- Motorul este echipat cu rulmenti ce garanteaza pana la 30.000 de ore de functionare continua fara probleme mecanice.
- Motor prevazut cu doua viteze.
- Viteza poate fi reglata prin variatoare de viteza optionale.
- Poate fi controlat prin senzori de mediu Vortice si variator cu doua trepte de viteza.
- Disponibil cu timer reglabil de la 3 la 20 de minute (modelul T)
- Plaja larga de temperaturi de functionare continua cuprinsa intre -25°C si +60°C
- Clasa protectie: IP44
- Nivel izolatie: II □

## DATE TEHNICE

Model	Cod	W		A		RPM		Debit				Presiune				Lp dB(A)*		Temp Max °C
		min	max	min	max	min	max	min	max	min	max	min	max	min	max	min	max	
VORTICE LINEO 100 V0	17001	20	23	0.09	0.11	1520	2000	180	255	50	70.8	13	16.5	127.5	161.9	30.7	39.4	60
VORTICE LINEO 100 T V0	17021																	
VORTICE LINEO 125 V0	17002	25	33	0.11	0.15	1570	2140	250	365	69.4	101.4	13	17	127.5	166.8	33.9	43	
VORTICE LINEO 125 T V0	17022																	
VORTICE LINEO 150 V0	17003	40	58	0.18	0.26	1580	2100	385	550	106.9	152.8	21	27	206	264.9	41.4	50.5	
VORTICE LINEO 150 T V0	17023																	
VORTICE LINEO 160 V0	17004	40	58	0.18	0.26	1580	2100	385	550	106.9	152.8	21	27	206	264.9	41.7	50.8	
VORTICE LINEO 160 T V0	17024																	
VORTICE LINEO 200 V0	17006	98	145	0.43	0.64	1580	2140	790	1060	219.4	294.4	29	33	284.5	323.7	46.2	52.5	
VORTICE LINEO 200 T V0	17026																	
VORTICE LINEO 250 V0	17009	110	180	0.48	0.78	1900	2550	990	1350	275	375	36	53	353.5	519.9	51.4	59.1	
VORTICE LINEO 315 V0	17010	200	300	0.90	1.32	1780	2450	1740	2300	483.3	638.9	43.5	75	426.7	735.8	50.6	63.4	

\* Nivel sunet masurat la 3 metri in camp liber in mod de functionare conform standardului de EN ISO 3741:2009

Tensiune alimentare: 220-240 V - 50 Hz



## DIMENSIUNI

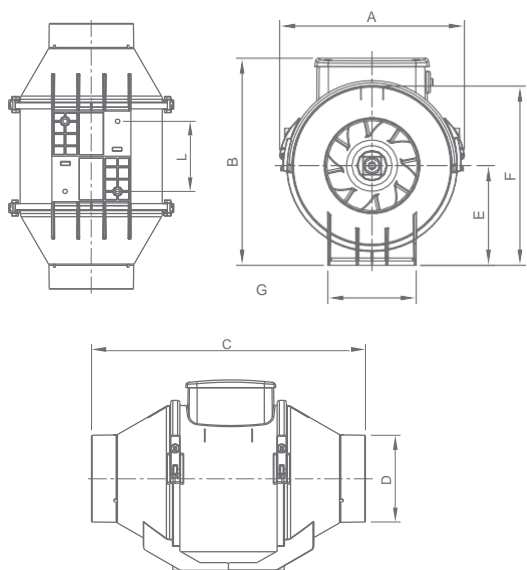

Model	A	B	C	ØD	E	F	G	L	Kg
VORTICE LINEO 100 V0	188.5	211	303	96	101.5	189	90	80	1.8
VORTICE LINEO 100 T V0									
VORTICE LINEO 125 V0	188.5	211	258	122	101.5	189	90	80	1.8
VORTICE LINEO 125 T V0									
VORTICE LINEO 150 V0	214.5	234	294	146	112.5	212	110	80	2.4
VORTICE LINEO 150 T V0									
VORTICE LINEO 160 V0	214.5	234	272.5	156	112.5	212	110	80	2.4
VORTICE LINEO 160 T V0									
VORTICE LINEO 315 V0	361.5	394.5	448	312	188.5	359	220.5	182	11.3

Dimensions (mm)

## INSTALARE

Ventilatoarele Lineo Vortice pot fi montate in diverse moduri – la inceputul, la mijlocul sau la terminarea tubulaturii si orizontal, vertical, prins de perete, tavan, tavan fals si orice alta suprafata plana. Mentenanta si inspectie usoara, in doar cateva secunde. Pot fi montate pe tevi standard rotunde sau pe tubulatura dreptunghiulara cu ajutorul accesoriilor special de montaj.

CA UNITATE SINGULARA LA INTRODUCERE



CA UNITATE SINGULARA LA EVACUARE



CA UNITATE SINGULARA PRIN TUBULATURA



## NIVEL SUNET PRESIUNE

Model	Cod	Nivel sunet presiune [db(A)] *EN ISO 3741:1999	
		min	max
VORTICE LINEO 100 V0	17001	25	30
VORTICE LINEO 100 TV0	17021		
VORTICE LINEO 125 V0	17002	27	33
VORTICE LINEO 125 TV0	17022		
VORTICE LINEO 150 V0	17003	28	33
VORTICE LINEO 150 TV0	17023		
VORTICE LINEO 160 V0	17004	28	34
VORTICE LINEO 160 TV0	17024		
VORTICE LINEO 200 V0	17006	46.2	52.5
VORTICE LINEO 200 TV0	17026		
VORTICE LINEO 250 V0	17009	51.4	59.1
VORTICE LINEO 315 V0	17010	50.6	63.4

Nivel sunet masurat la 3 m in aer liber cu produsul prins de tubulatura complet.

## NIVEL SUNET

Model	Cod	125 Hz	250 Hz	500 Hz	1000 Hz	2000 Hz	4000 Hz	8000 Hz	Lw dB(A)
VORTICE LINEO 100 V0	17001	52.3	62.3	58.6	53.5	51.0	42.6	34.0	60
VORTICE LINEO 100 TV0	17021								
VORTICE LINEO 125 V0	17002	51.4	61.8	59.5	59.6	56.8	48.6	40.5	63.6
VORTICE LINEO 125 TV0	17022								
VORTICE LINEO 150 V0	17003	60.5	68.3	67.8	63.7	66.7	55.6	45.8	71.1
VORTICE LINEO 150 TV0	17023								
VORTICE LINEO 160 V0	17004	59.1	68.9	66.7	64.4	67.0	57.8	48.4	71.3
VORTICE LINEO 160 TV0	17024								
VORTICE LINEO 200 V0	17006	68.6	68.6	71.2	69.1	70.7	66.3	57.4	75.7
VORTICE LINEO 200 TV0	17026								
VORTICE LINEO 250 V0	17009	69.0	73.1	77.2	76.0	72.3	62.9	55.1	79.7
VORTICE LINEO 315 V0	17010	73.3	78.4	79.	81.1	76.5	67.6	59.6	83.9

## ACCESORII PRODUS

Model	Descriere Produs	Cod	VORTICE LINEO 100 V0 COD 17001	VORTICE LINEO 125 V0 COD 17002	VORTICE LINEO 150 V0 COD 17003	VORTICE LINEO 160 V0 COD 17004	VORTICE LINEO 200 V0 COD 17006	VORTICE LINEO 250 V0 COD 17009	VORTICE LINEO 315 V0 COD 17010
	C5 0.5 Variator de viteza 0.5 A	12987	•	•	•	•	•	•	•
	C 1.5 Variator de viteza electronic 1.5 A	12966	•	•	•	•	•	•	•
	C 2.5 Variator de viteza electronic 2.5 A	12967	•	•	•	•	•	•	•



CURBE DE PERFORMANTA

LINEO 100 V0 cod 17001 - LINEO 100 T V0 cod 17021

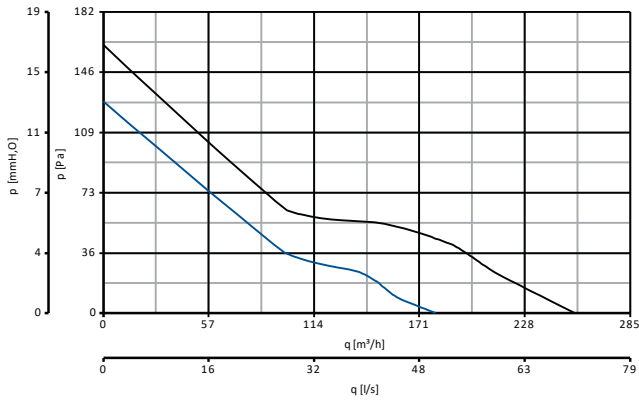

LINEO 125 V0 cod 17002 - LINEO 125 T V0 cod 17022

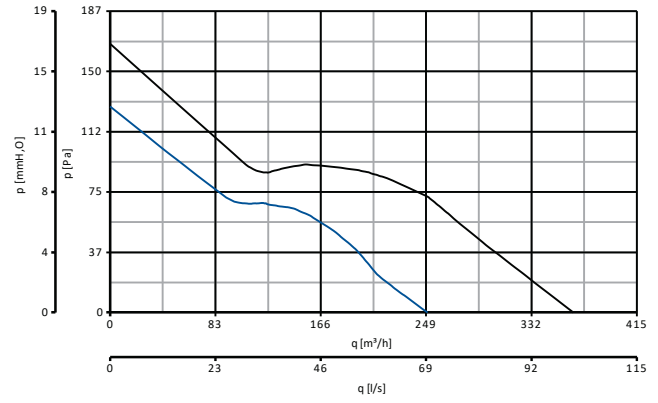

LINEO 150 V0 cod 17003 - LINEO 150 T V0 cod 17023

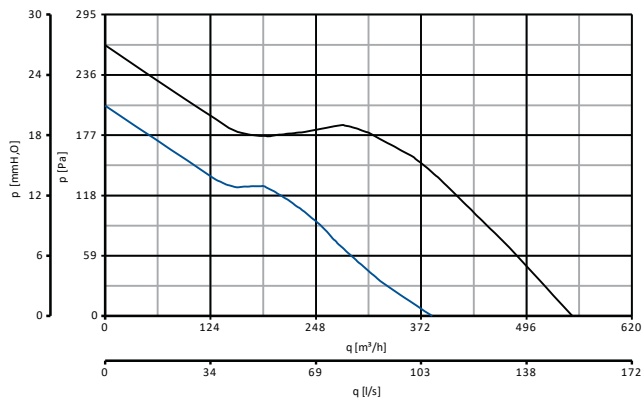

LINEO 160 V0 cod 17004 - LINEO 160 T V0 cod 17024

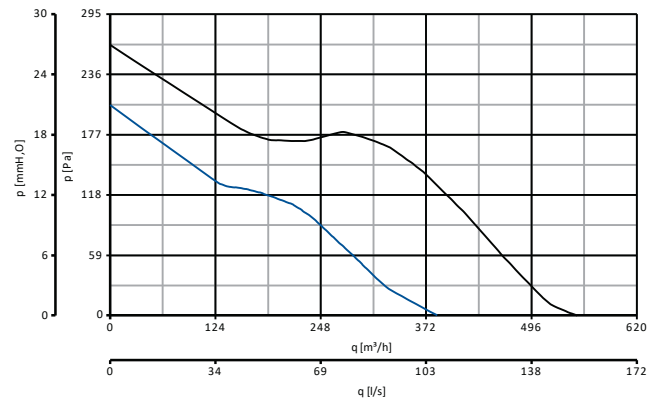

LINEO 200 V0 cod 17006 - LINEO 200 V0 T cod 17026

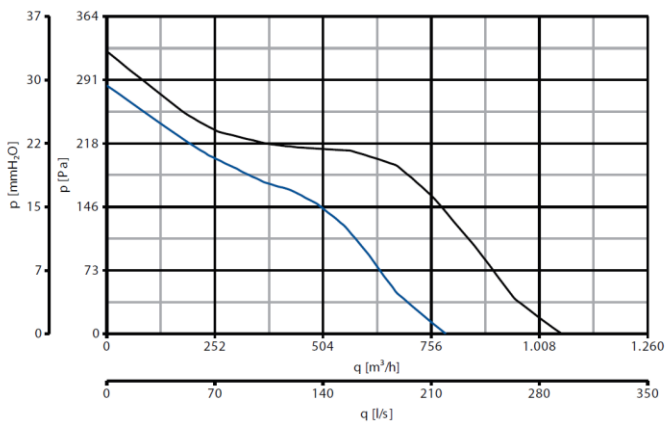

LINEO 250 V0 cod 17009

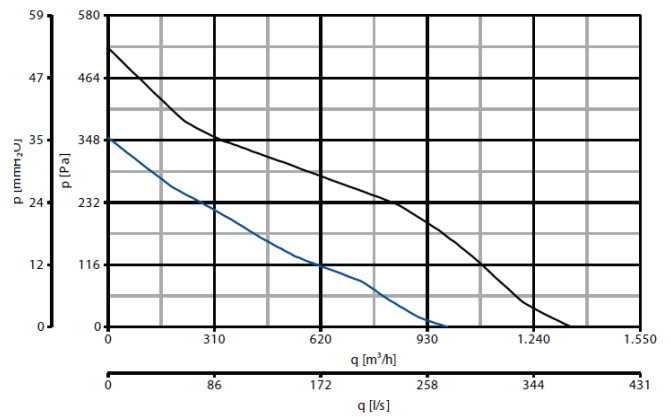

### LINEO 315 cod 17010

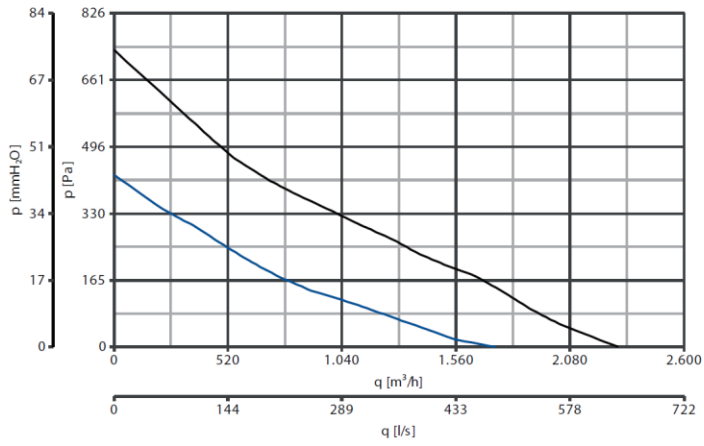

— min. — max.