

Descriere

Robinet fluture centric cu garnitura din Elastomer pentru lichide si gaze in domeniile industriale, servicii generale, tratarea apei, ...

Caracteristici

- Constructia corpului DP1 Wafer DN 25-600
DP3 Lug DN 50-400
 - Dimensiuni fata in fata in acord cu ISO 5752/20, EN 558-1/20
 - Flanse de capat in acord cu EN ISO 5211
 - Presiunea maxima de lucru 16/20 bar
 - Contraflanse de prindere PN6, PN10, PN16, PN25, ANSI cl. 150
 - Gama de temperatura -40°C ÷ 200°C in functie de material
 - Test de etansare in acord cu EN 12266-1/P12 rata de curgere A, testat cu apa
- Robinetii fluture DESPONIA PLUS satisfac cerintele de siguranta la presiune conform Directivei 97/23/EC (PED) appendix 1 pentru fluidele din grupa 1 si 2
- Robinetii fluture DESPONIA PLUS sunt potriviti pentru operare in acord cu IEC 61508 / 61511, Safety Integrity Level SIL 2

CE

SIL

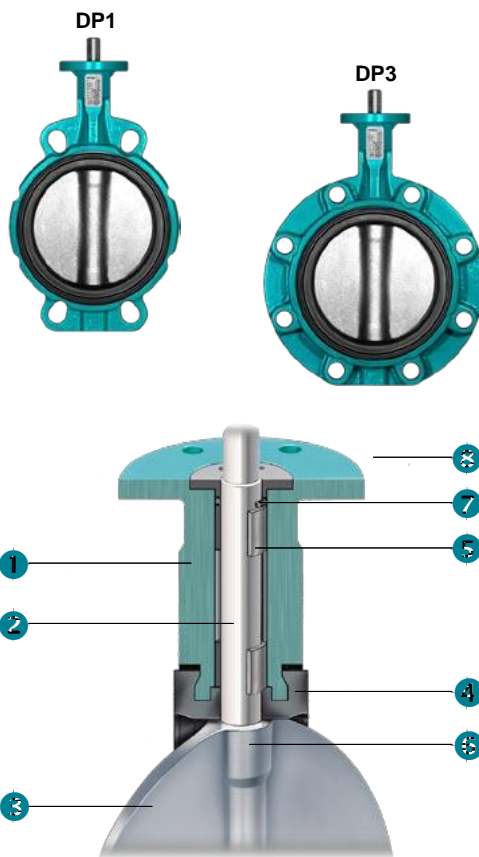

Constructie

1	Corp (profil cu gat extins ce permite izolarea)
2	Ax cu indicator de pozitie si protecti impotriva expulzarii
3	Disc
4	Garnitura interioara interschimbabila cu profil incastrat in corp si caneluri
5	Ax cu bucsa autolubrifianta
6	Patrat de actionare a discului
7	Etansare externa a axului
8	Piulita de retinere (protectie impotriva expulzarii axului)

Codificare

DP1	100	3	3	2AE	4A	2AR	E
1	2	3	4	5	6	7	8

1	Tipul corpului	DP1	Wafer	DN25-600	
2	Diametru nominal	DP3	Lug	DN50-400	
3	Presiunea de lucru	→	1 = 6 bar, 2 = 10bar, 3 = 16bar, 4 = 20bar (doar cu corp 3HE or 4C0, pentru 2AE consultati departamentul tehnic)		
4	Prindere contraflanse	→	1 = PN6, 2 = PN10, 3 = PN16, A = ANSI cl. 150, 5 = PN25 la cerere		
5	Corp	2AE	Fonta ductila EN-GJS-400-15, acoperire Polyuretana 70µ	< 140°C	DP1+DP3, DN25-400
		3HE	Otel turnat GP240GH, 1.0619, acoperire Polyuretana 70µ	< 140°C	DP1 DN50-600, DP3 DN50-300
		4C0	Otel inox 1.4408, AISI316		DP1 DN50-600, DP3 DN50-300
6	Ax	41	Otel inox 1.4021, AISI420 (max.16 bar)		DN 25-DN300
		42	Otel inox 1.4542 / 17-4PH		DN 25-DN300
		4A	Otel inox 1.4021, AISI420 (max.16 bar)		DN350-DN600
		4L	Otel inox 1.4542 / 17-4PH		DN350-DN600
7	Disc	2AR	Fonta ductila EN-GJS-400-15, acoperire Rilsan 250µ (max.16 bar)	< 90°C<16 bar	DN25-600
		2AE	Fonta ductila EN-GJS-400-15, acoperire Polyuretana 70µ (max.16 bar)	< 120°C	DN25-600
		3HE	Otel turnat GP240GH, 1.0619, acoperire Polyuretana 70µ	< 120°C	DN250-600
		3OD	Otel carbon 1.0552 / GS52.3, acoperire Ultralene™ acoperit < 80°C, pmax. 10 ≤ DN400 / 6 bar>DN400		DN80-300
		4C0	Otel inox 1.4408, AISI316		DN25-600
		4CP	Otel inox 1.4408, AISI316, lustruit (max.16 bar)		DN25-600
		4S0	Otel super austenitic 1.4588		DN40-400
		5C0	Bronzaluminiu ASTM B148 C95800 / G-Cu Al 10 Ni (max.16 bar)		DN25-600
7H0	Hastelloy ASTM A494 CW-12MW (max.16 bar)		DN40-400		
8	Garnitura	→	E = EPDM < 95°C N = Nitril (NBR) < 100°C Alte materiale si garnituri albe la cerere	EC = EPDM HT < 130°C H = CSM (Hypalon) < 125°C	V = FPM (Viton) < 200°C<16 bar
					S = MVQ (Silicone) <200°C <6bar

Limitele maxime de presiune si temperatura ale aplicatiei depin de conditiile de lucru.



Prescriptii la montajul unui robinet la capat de coloana:

- tipul corpului	DP3
- Mediul de lucru	Doar pentru lichide, 10÷30°C
- presiunea maxima de lucru	DN25-200 10 bar
(cu 16 bar disc)	DN250-600 6 bar

- Fara lovituri de berbece !!!

Va rugam consultati documentatia "Flanse"

Fluids under control.

Dimensiuni

DP1 Corp Wafer, DN 25-600

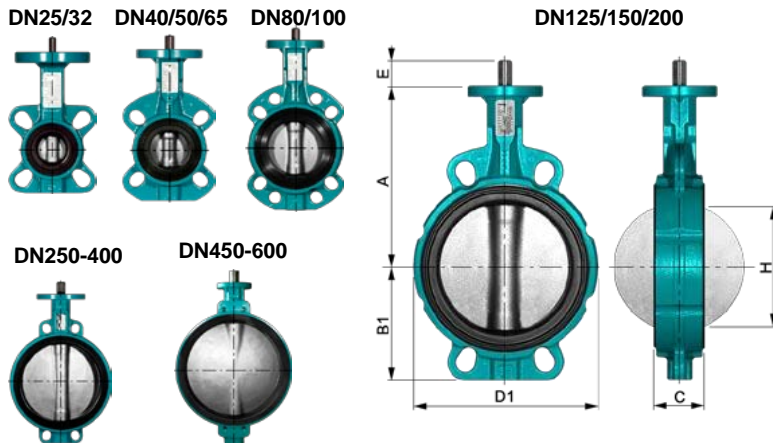

DN	A	B1	C	D1	E	H*	x*	[kg]
25/32	110	51	30	101	19	19	3	1,4
40	130	54	33	108	19	28	6	2,0
50	135	72	43	120	19	32	6	3,0
65	150	82	46	138	19	50	11	3,6
80	160	92	46	142	19	69	19	4,0
100	180	102	52	162	19	88	26	5,5
125	195	120	56	189	19	115	36	7,5
150	210	133	56	214	19	141	48	8,6
200	240	166	60	270	25	194	72	12,7
250	279	201	68	324	32	240	91	22,2
300	315	234	78	378	32	290	112	30,8
350	330	268	80	425	40	330	130	41,5
400	365	299	102	475	40	377	145	57,2
450	397	355	113	538	65	425	164	95,0
500	437	393	126	595	65	474	182	125
600	522	464	153	695	80	569	218	180

* La utilizarea axurilor de plastic, va rugam verificati dimensiune H / x pentru a evita avarierea discului.

DP3 Corp LUG, DN 50-400

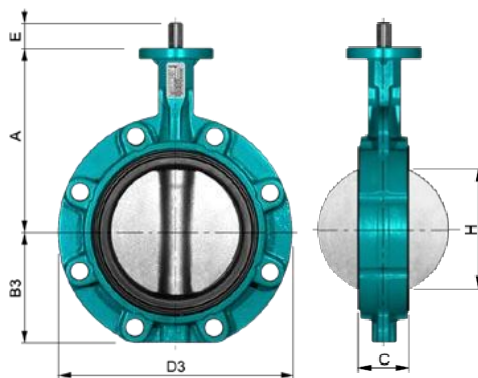

DN	A	B3	C	D3	E	H*	x*	[kg]
50	135	72	43	116	19	32	6	3,2
65	150	82	46	131	19	50	11	4,0
80	160	88	46	188	19	69	19	6,1
100	180	102	52	219	19	88	26	8,5
125	195	116	56	248	19	115	36	10,0
150	210	128	56	274	19	141	48	11,0
200	240	161	60	332	25	194	72	19,6
250	279	199	68	402	32	240	91	28,7
300	315	234	78	472	32	290	112	41,2
350	330	258	80	520	40	330	130	55,0
400	365	290	102	584	40	377	145	75,0

Flanse de capat in acord cu EN ISO 5211

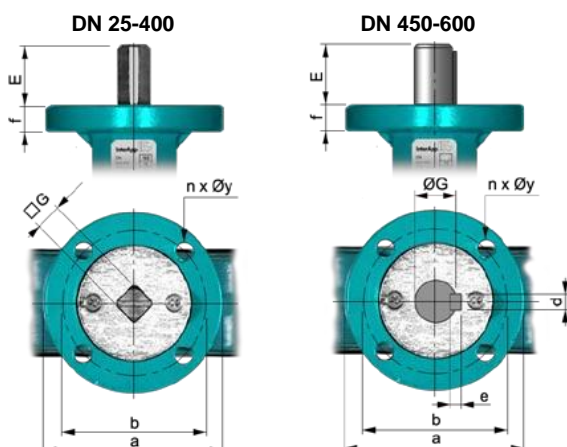

DN	E	G	d	e	f	ISO	a	b	n x øy
25/32	19	□ 8	-	-	12	F07	90	70	4 x 9
40	19	□ 8	-	-	12	F07	90	70	4 x 9
50	19	□ 11	-	-	12	F07	90	70	4 x 9
65	19	□ 11	-	-	12	F07	90	70	4 x 9
80	19	□ 11	-	-	12	F07	90	70	4 x 9
100	19	□ 11	-	-	12	F07	90	70	4 x 9
125	19	□ 14	-	-	12	F07	90	70	4 x 9
150	19	□ 14	-	-	12	F07	90	70	4 x 9
200	25	□ 17	-	-	12	F07	90	70	4 x 9
250	32	□ 22	-	-	18	F10/F12	155	102/125	4 x 10 / 4 x 13
300	32	□ 22	-	-	18	F10/F12	155	102/125	4 x 10 / 4 x 13
350	40	□ 22	-	-	18	F12	155	125	4 x 13
400	40	□ 27	-	-	18	F12	155	125	4 x 13
450	65	ø 45	14	9	25	F14	175	140	4 x 18
500	65	ø 45	14	9	25	F14	175	140	4 x 18
600	80	ø 70	20	12	25	F16	220	165	4 x 22

Documentatie suplimentara

Actuator pneumatic, actuator electric, Accesorii in acord cu fisele tehnice separate.

Manual de instalare, manual de service, Flanse: Va rugam consultati aceste ghiduri pentru instalarea si intretinerea robinetilor fluture.

InterApp AG
Grundstrasse 24
CH-6343 Rotkreuz
Phone +41 (0) 41 7982233
Fax +41 (0) 41 7982234
info@ch.interapp.net

InterApp Austria
Kolpingstrasse 19
A-1230 Wien
Phone +43 (0) 1 6162371-0
Fax +43 (0) 1 6162371-99
info@at.interapp.net

InterApp Italy
Via Gramsci 29
I-20016 Pero (MI)
Phone +39 02 339371
Fax +39 02 33937200
info@it.interapp.net

Karinam Industry
Str. Islaz, nr. 11
Barlad, jud. Vaslui
Tel. +40.335.800.905
Fax +40.335.800.905
office@karinam.ro

AVK Mittelmarm Armaturen
InterApp Germany
Schillerstrasse 50
D-42489 Wülfrath
Phone +49 (0) 2058 901 01
Fax +49 (0) 2058 901 110
info@avkmittelmarm.com

AVK Válvulas S.A.
InterApp Válvulas S.A.
Poligono Industrial Francoli, parcela 27
E-46006 Tarragona
Phone +34 977 543 008
Fax +34 977 541 622
avk@avkvalvulas.com